

QUICK USER GUIDE

Security NVR Kit - IQ Series



ONWOTE

www.onwote.com
support@onwote.com

Contents

Safety Cautions	2
1. NVR Connection Diagram	3
Wizard Setup	6
2. Play Audio & Name Cameras	9
How to Play Audio	9
Name Your Cameras	9
3. Access System Using Mobile Device	10
4. Access System Using PC Client Software	13
5. Access System Using a Browser	19
6. Recording Setup	21
Set the Detection Area	21
Normal Recording	23
Event Recording	23
7. Video Playback	25
8. Video Backup	28
9. Mobile App & E-mail Notifications	33
10. Smart Motion Detection & VCA/AI Detection	37
11. AcuSearch and Face Comparison	38
12. Reset Password	45

Safety Cautions

- Please read this user manual carefully to ensure that you can use the device correctly and safely. This manual applies to multiple models.
- All examples and pictures in this manual are provided for reference purposes only and may vary by model.
- This manual may contain technical inaccuracies or typographical errors. Updates will be included in future versions of this manual. The contents of this manual are subject to change without prior notice.
This device should be operated only with the power source indicated on the product label. Please verify the power voltage before using the device. Disconnect the device from the power source if it will not be used for an extended period of time.
- Use the device within the specified power range; otherwise, it may cause a power supply short circuit or device failure.
- Use the navigation menu or power switch to shut down the device. Do not unplug the power directly. A sudden power failure may cause device damage and data loss.
- Do not install this device near heat sources such as radiators, heat registers, stoves, or other heat-producing equipment.
- Do not install this device near water. Clean the device only with a dry cloth.
- Do not block any ventilation openings, and ensure proper airflow around the device.
- Do not power off the device while recording is in progress.
This device is intended for indoor use only. Do not expose it to rain or humid environments. If any solid object or liquid enters the device, turn it off immediately and have it inspected by a qualified technician.
- Do not attempt to repair the device yourself without professional assistance or authorization.
- This product may involve services or content related to Microsoft, Apple, and Google during use. The pictures and screenshots in this manual are provided solely to illustrate the use of our product. All trademarks, logos, and intellectual property related to Microsoft, Apple, and Google are the property of their respective owners.

1

NVR Connection Diagram

Hook up a monitor to the NVR to set up the system.

ONWOTE 8CH PoE NVR Connection Diagram:

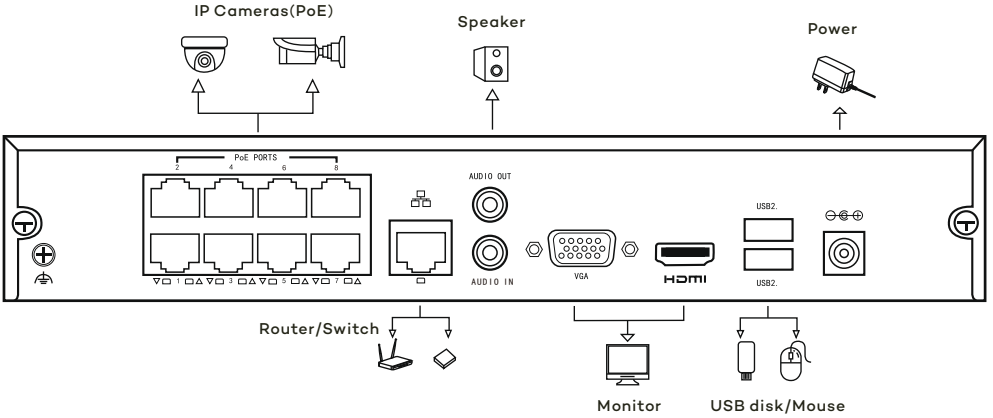

ONWOTE 16CH PoE NVR Connection Diagram:

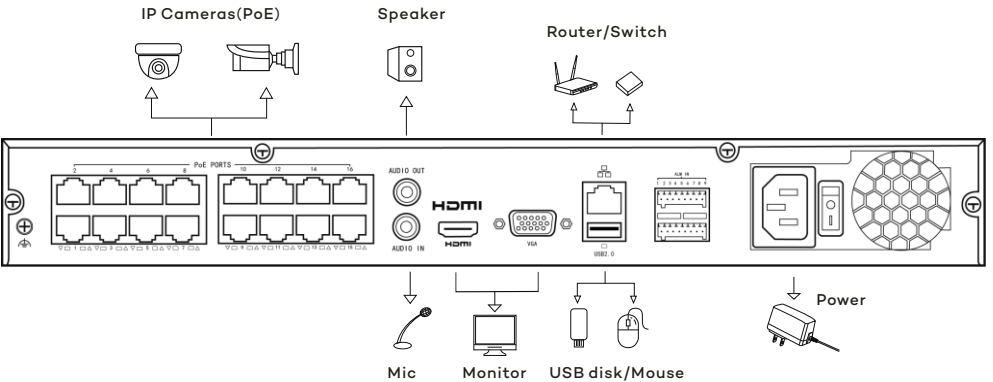

ONWOTE 32CH NVR + 24CH PoE Switch + 8CH PoE Switch + 32 PoE Cameras

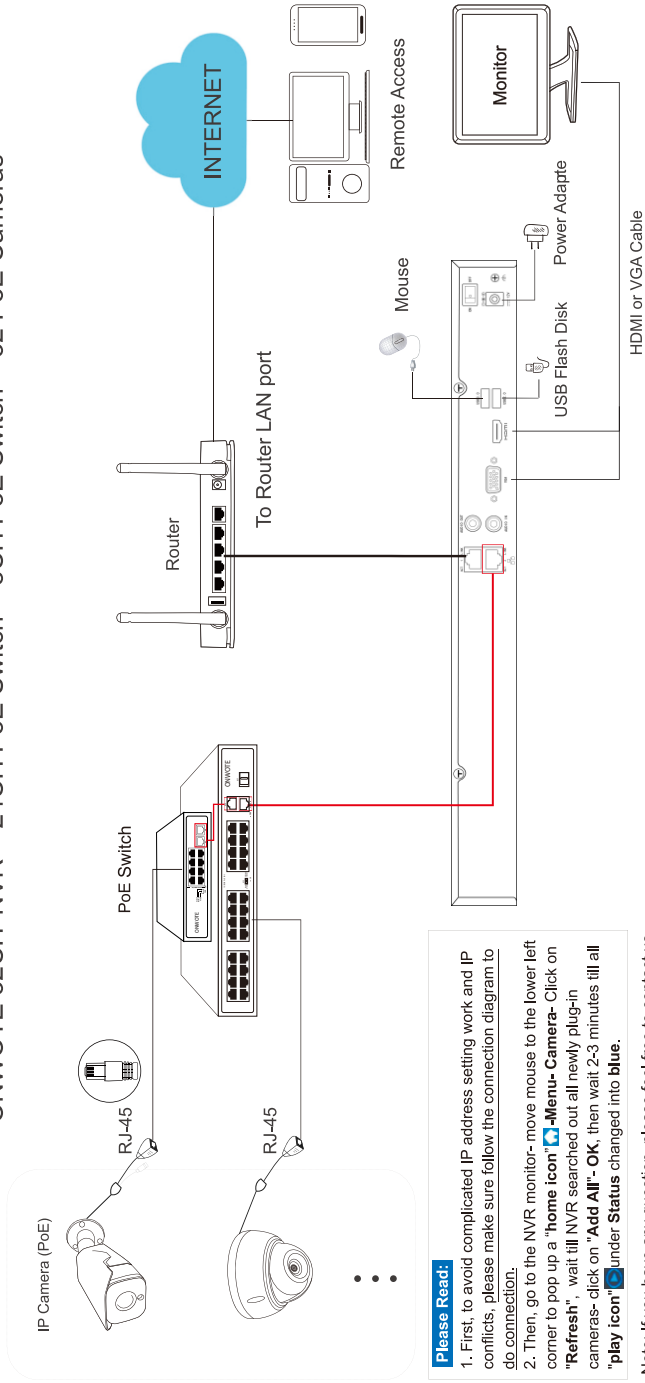

Please Read:

1. First, to avoid complicated IP address setting work and IP conflicts, please make sure you follow the connection diagram to do connection.
2. Then, go to the NVR monitor- move mouse to the lower left corner to pop up a "home icon"  -Menu- Camera- Click on "Refresh", wait till NVR searched out all newly plug-in cameras- click on "Add All" - OK, then wait 2-3 minutes till all "play icon"  under Status changed into blue.

Note: If you have any question, please feel free to contact us at support@onwote.com

ONWOTE 64-CH NVR + 24CH PoE Switch + 24CH PoE Switch + 16 CH PoE Switch + 64 PoE Cameras

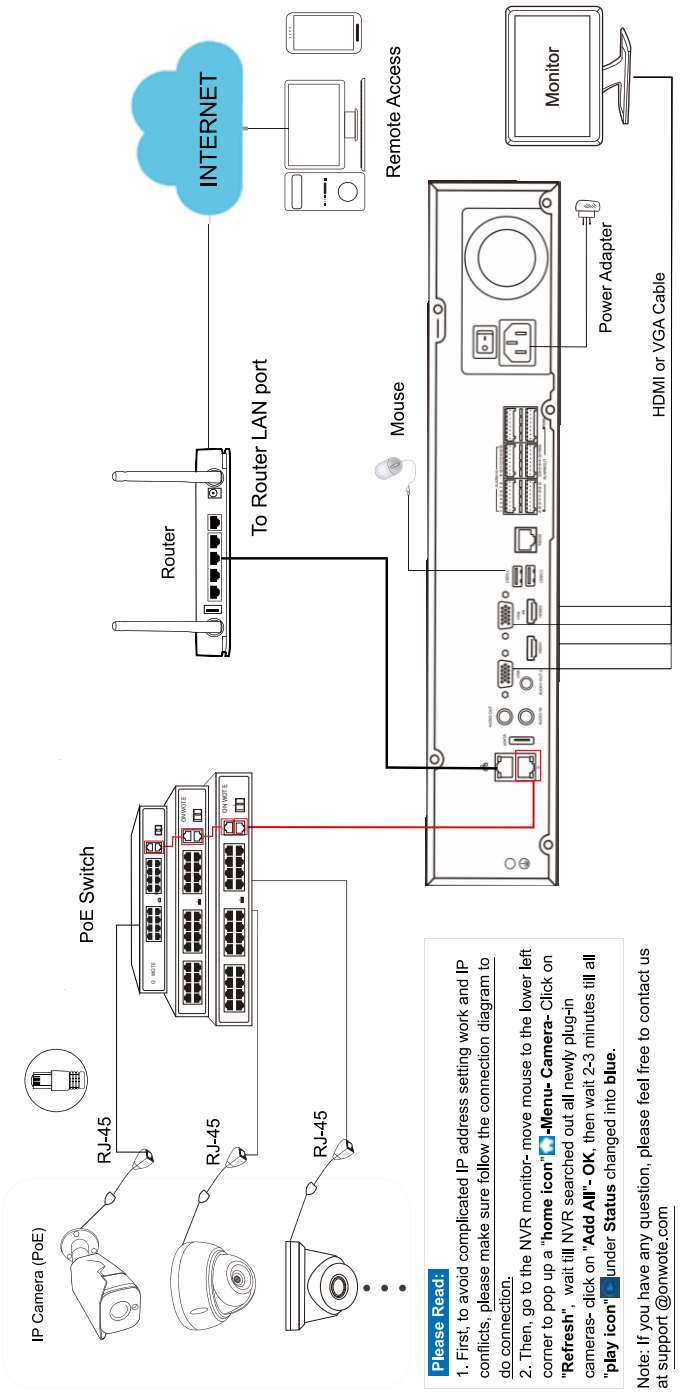

- Please Read:**
1. First, to avoid complicated IP address setting work and IP conflicts, please make sure you follow the connection diagram to do connection.
 2. Then, go to the NVR monitor- move mouse to the lower left corner to pop up a "home icon" **Menu- Camera**- Click on "Refresh", wait till NVR searched out all newly plug-in cameras- click on "Add All" - OK, then wait 2-3 minutes till all "play icon" **Under Status** changed into **blue**.
- Note: If you have any question, please feel free to contact us at support @onwote.com

Wizard Setup

1. Select the language.

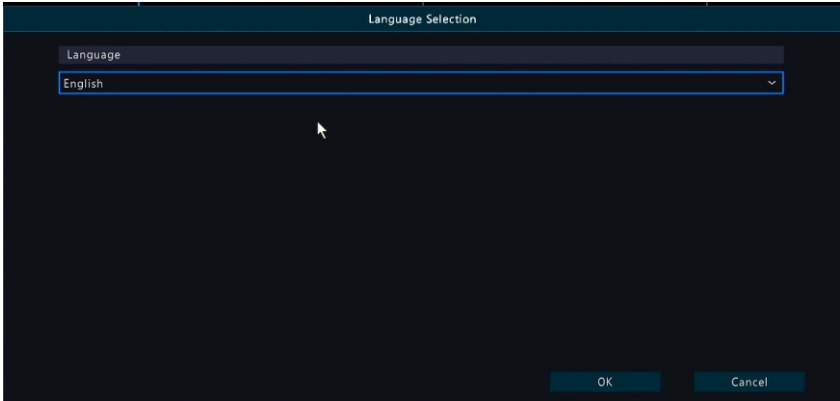

2. Login (Default credentials: Username : **admin** Password: **123456**).

3. Change the password. Enter the old password, the new password and your email address.

Tips: The old password is 123456. The new password must be strong and contain a combination of letters, numbers, and special characters.

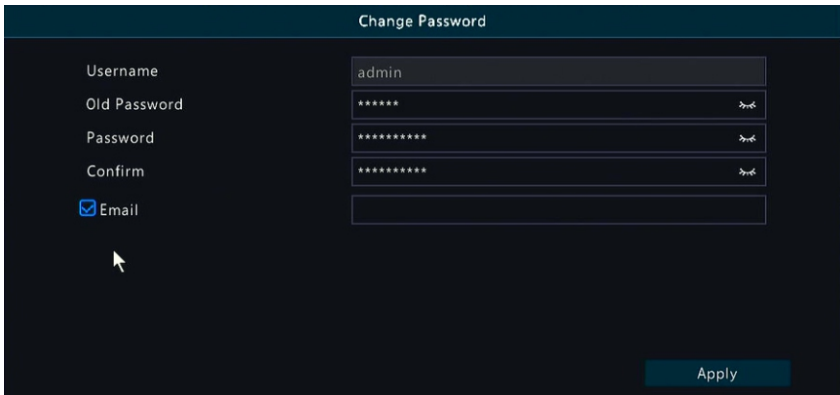

4. Set an unlock pattern for the system or skip this step if it is not needed.

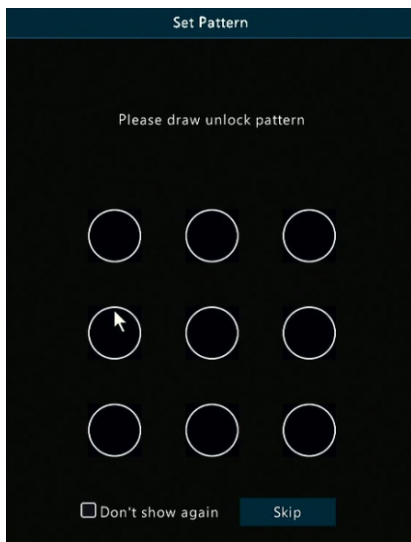

5. Set the time and select “**Enable DST**” if daylight saving time is used in your region.



6. Keep the default network settings and click “**Next**”.

*Tips: If you use a static IP address, disable “**Enable DHCP**” and configure the IP address manually*

7. Scan the QR code to download the mobile app and add the device to the app (Please refer to Page 10 for detailed steps).

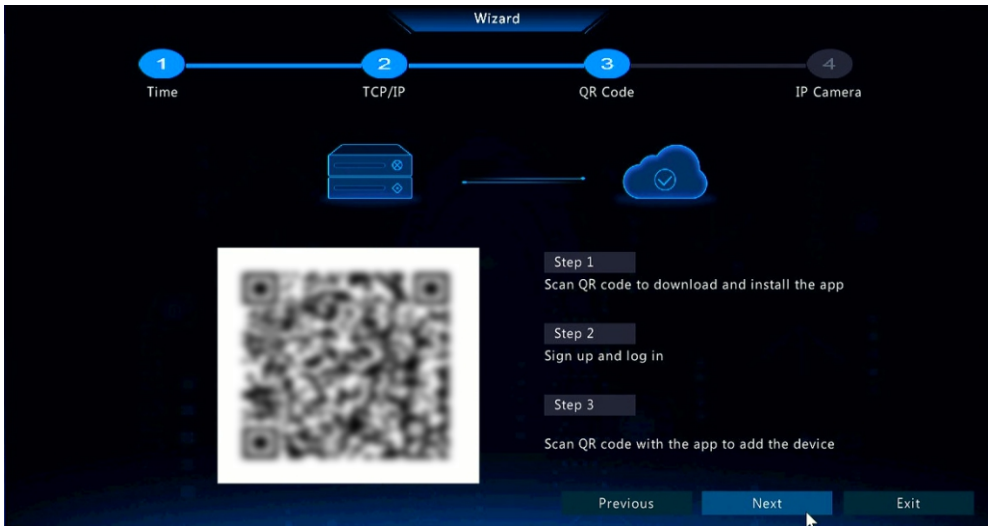

8. Add cameras. Select all cameras and click “+Add” to add them.

Tips:

- To add more cameras after the wizard setup, go to NVR Menu -> Camera, then click “Add All” at the top of the screen.
- If you are using an 8-channel or 16-channel NVR, this step will not be displayed. All cameras connected to the NVR will be detected automatically.



2

Play Audio & Name Cameras

Default Credentials: Username: **admin** Password: **123456**

How to Play Audio

Click the channel to select the camera, then click  to play audio. You can play audio from only one channel at a time.

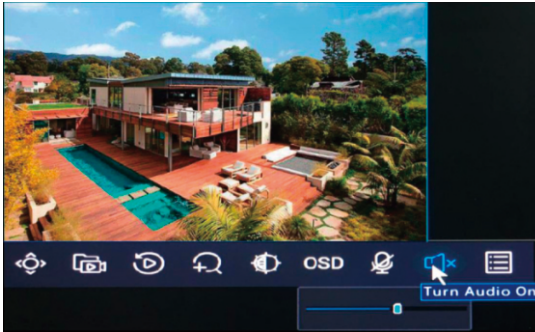

Note

1. If your monitor does not have a built-in speaker or does not support audio via HDMI, audio may not be output.
2. Some ONWOTE cameras do not support audio.

Name Your Cameras

Click the channel to select the camera, click OSD to edit the camera name.



3

Access System Using Mobile Device

Make sure the NVR is connected to the router with an Ethernet cable to access the Internet.

1. Download the **Elink Defense** app from Apple App Store or Google Play.



Elink



QR code

2. Find the device QR code on the bottom of the NVR. If you cannot find the QR code on the NVR, right-click on the NVR monitor and go to **Menu --> System --> Network --> P2P** to display it.

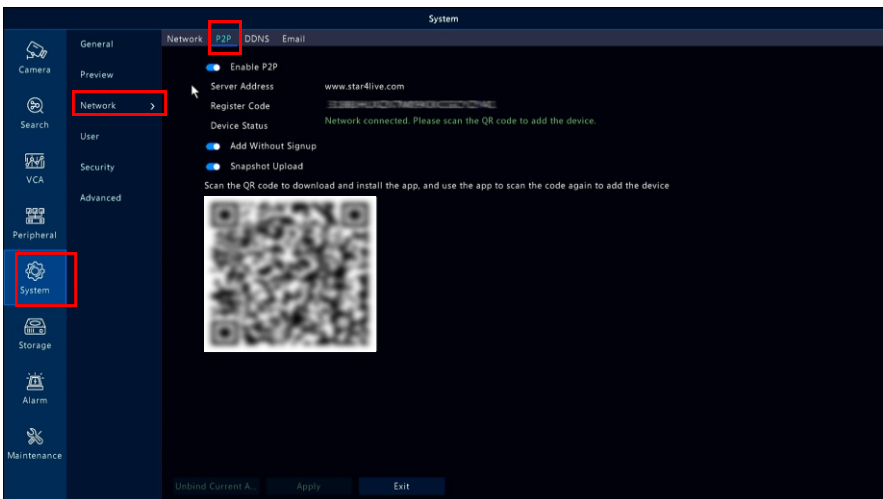

3. Tap **Log in/Sign Up**, then tap **Sign Up** to register an account.

4. Select your region at the top right corner. Enter your email address, check "I have read and agree to << Service Agreement >> and << Privacy Policy >>". Then tap **Send Code**.

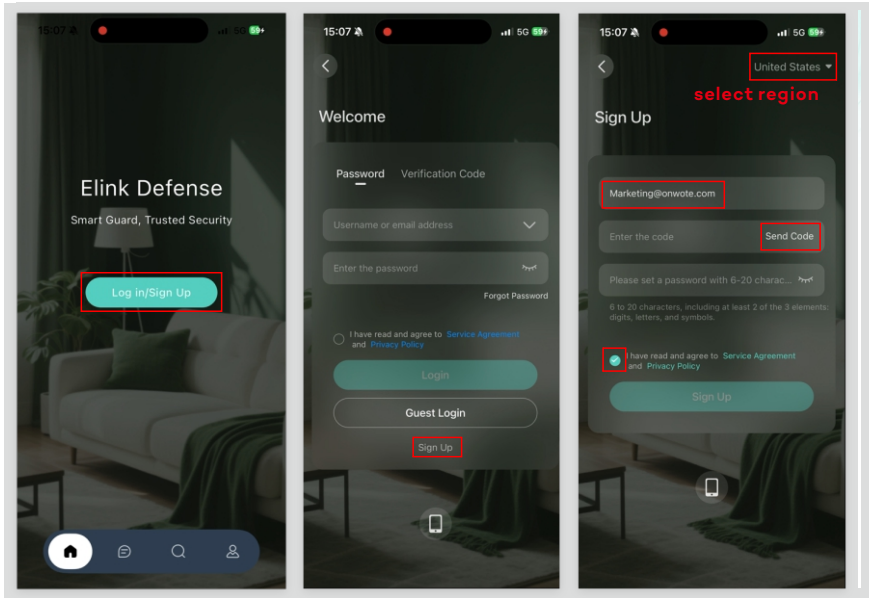

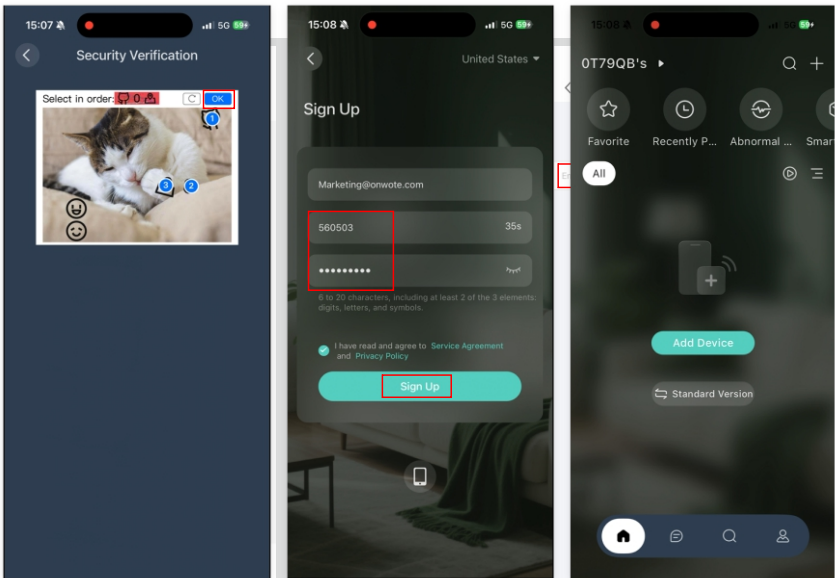

5. Complete the security verification, then tap **OK** to get a verification code.
- Tip: If you do not receive the verification email, please check your inbox and spam/junk folder.*
6. Enter the verification code, create a password, then tap **Sign Up**.
 7. Tap **Add Device** to scan the NVR QR code (refer to Step 2 for the QR code).

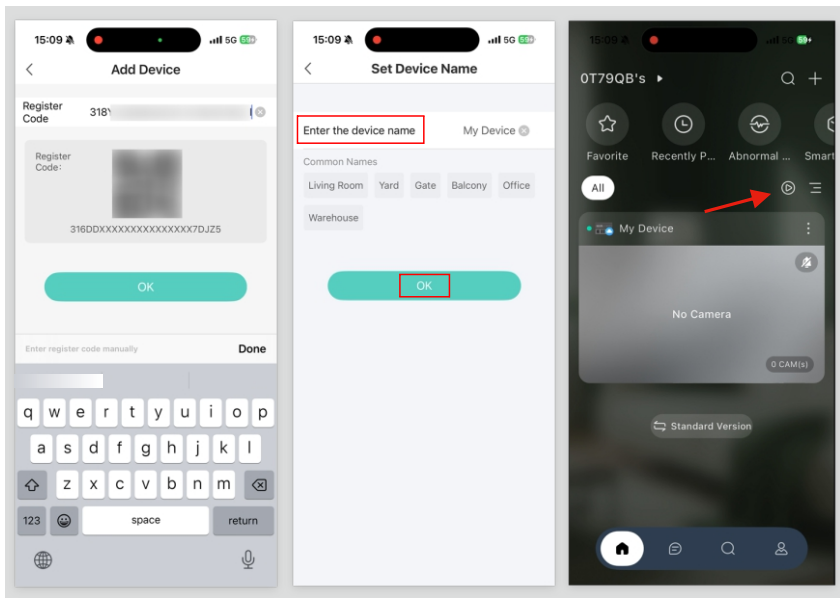

8. Tap **OK**, then enter a name for the camera system. Tap **OK** again.

9. Tap  to view the live video.



10. Tap the video image, then tap  to enable audio. If your camera supports two-way audio, tap  at the bottom to start two-way audio.

11. Tap **Playback** to view recordings.

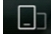
12. Rotate your phone to landscape orientation or tap the  to view the video in full screen.

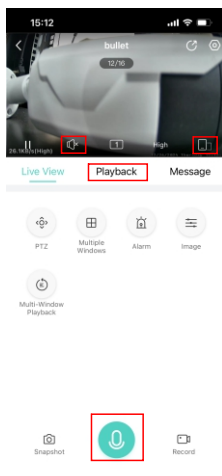

4

Access System Using PC Client Software

Please download the PC client software at: www.onwote.com:

Support--> Download Center--> Software--> NVR30...Series

Download the PC client software on a Windows PC or Mac, install **Guard Station**.

***Tips:** If your Mac doesn't allow you to install the software, choose Apple **System Settings**, then click **Privacy & Security** in the sidebar. (You may need to scroll down.) Go to **Security**, click **Open Anyway**, enter your login password to allow the Mac to install the app.*

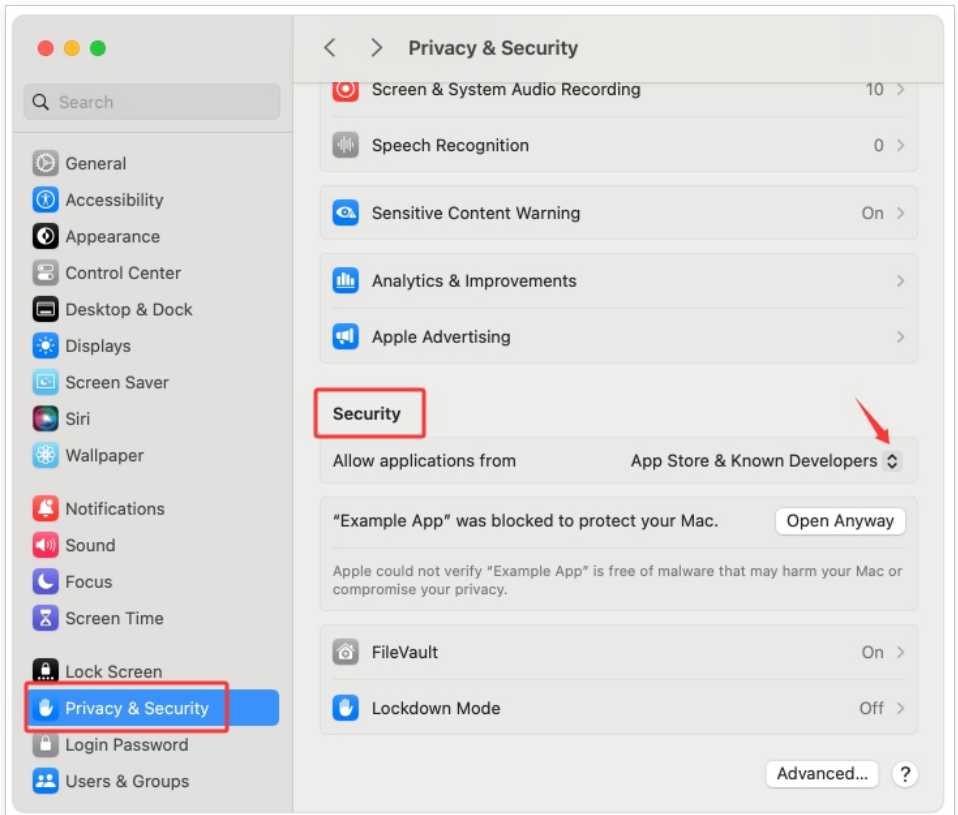

a. Launch Guard Station and create an Administrator. Enter a password and click on **Next**. Set security questions and click on **OK**.

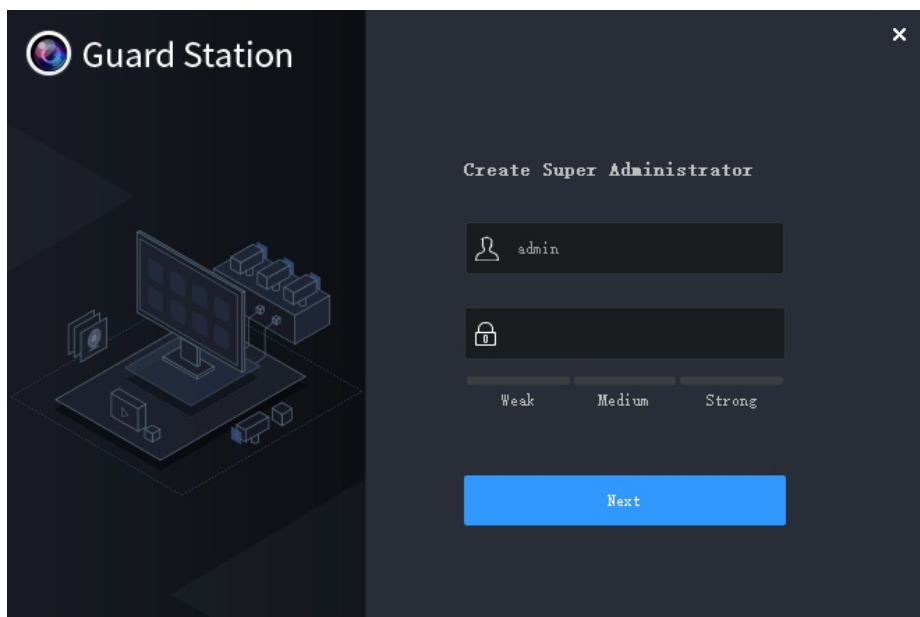

Guard Station

Create Super Administrator

admin

Weak Medium Strong

Next

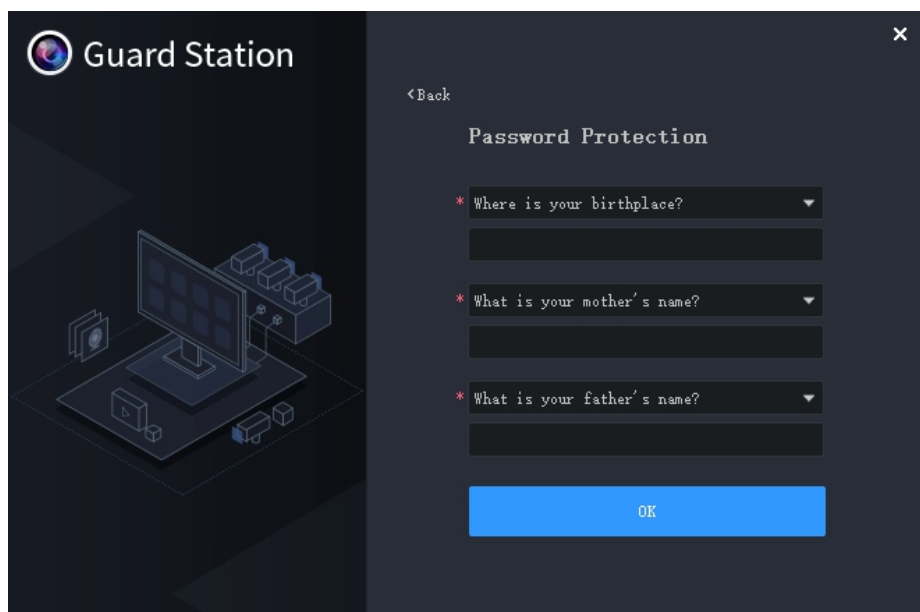

Guard Station

<Back

Password Protection

* Where is your birthplace?

* What is your mother's name?

* What is your father's name?

OK

b. Log in with the user you created. Go to **Control Panel**, click **Device Management** to add device.

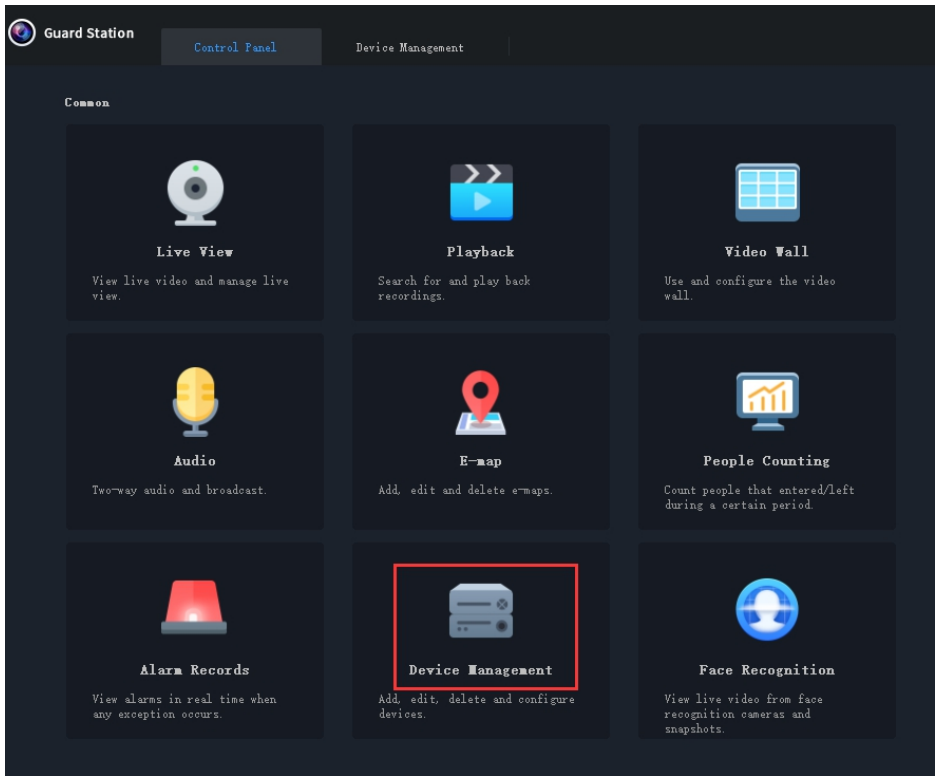

c. Click **Cloud Device** and **Register** to register a cloud account (If you've already registered an account on your mobile app-**Elink Defense**, Log in with that account directly).

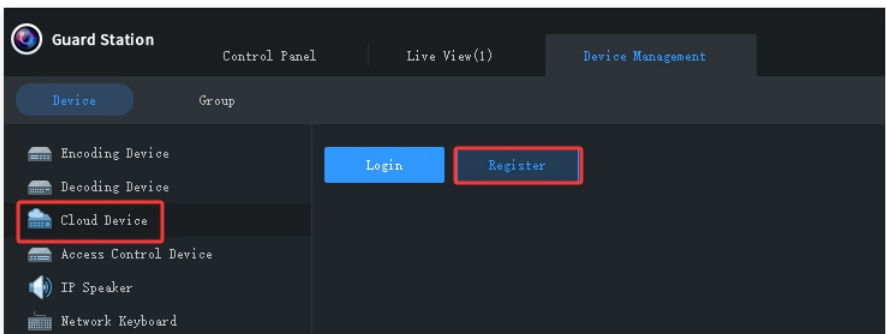

d. Type in a username, select region, enter your email address, verification code and set a password, click **Register** to sign up for an account.

Already got an account? [Log In](#)

Register

* Username: **Set a username for account**
1-20 characters, including letters(A-Z, a-z), digits(0-9...

* Region: **Select a region**

Register Using: Email Mobile Phone Number

Enter your email address, click on send code

* Email:

* Verification Code: **Enter the verification code**

* Password: **Set a password for your account**

* Confirm Password: **Confirm your password**

have read and agree to [Service Agreement](#) and [Privacy Policy](#)

e. Click **+Add** to add device.

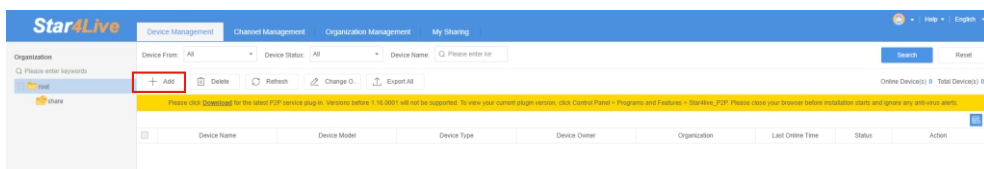

f. Input the **Register Code** and click on **Add**. Then set a name for your device and click on **OK**.

(How to get Register code?—Right click on the NVR monitor,choose *Menu-->Network-->Basic-->P2P* to get the register code)

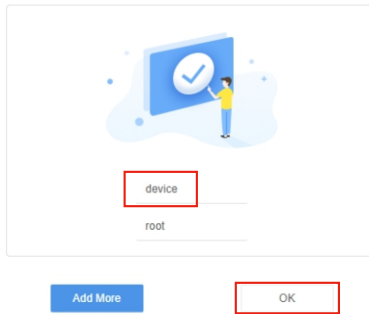
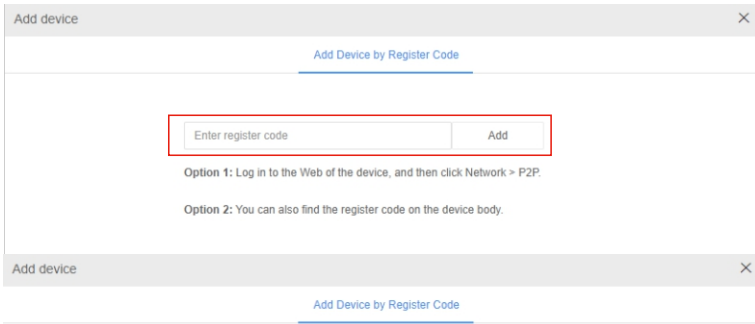

g. Go back to your PC client software- **Guard Station**, log in with the account you registered.

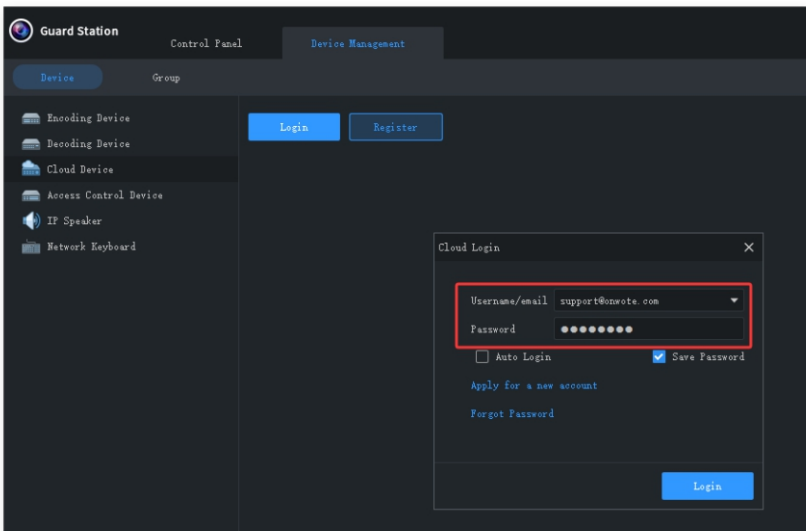

h. Go to **Live View** and double-click the device to view live video.

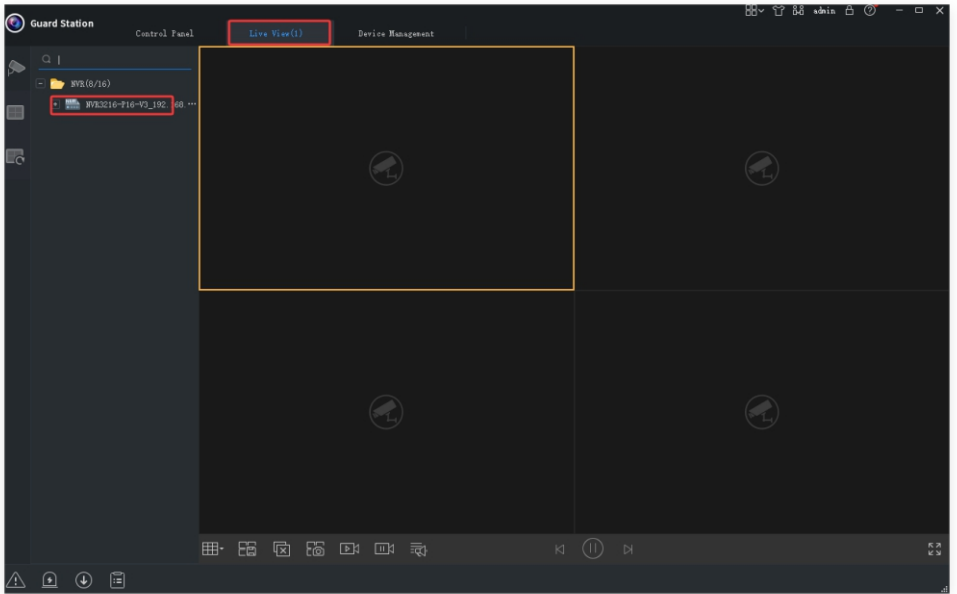

For audio cameras, move the mouse pointer over the channel to display the menu, click  to play audio.

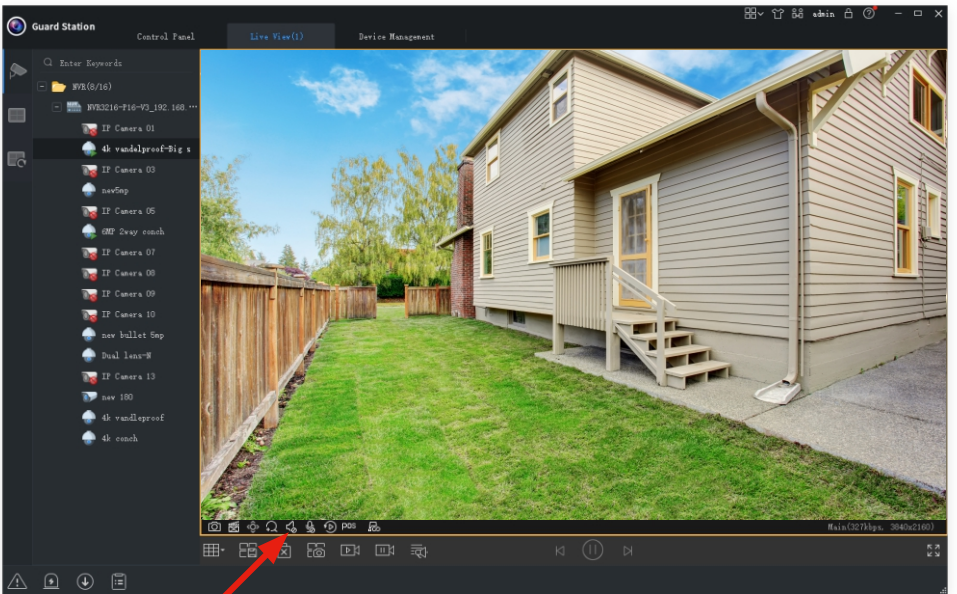

5

Access System Using a Browser

1. Find the **Register Code** of your device: right-click on the NVR monitor and go to **Menu --> System --> Network --> P2P**.

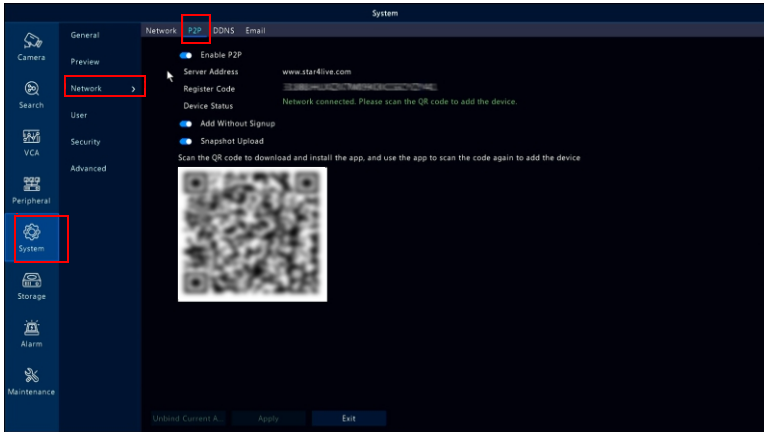

2. Enter www.star4live.com in your browser address bar.
3. Log in with the account you registered in the mobile app-**Elink Defense** or PC Client Software- **Guard Station**.

Tip: If you have not registered an account, click **Sign Up** and follow **Step d-f** on **page 16** to register an account and add the device.

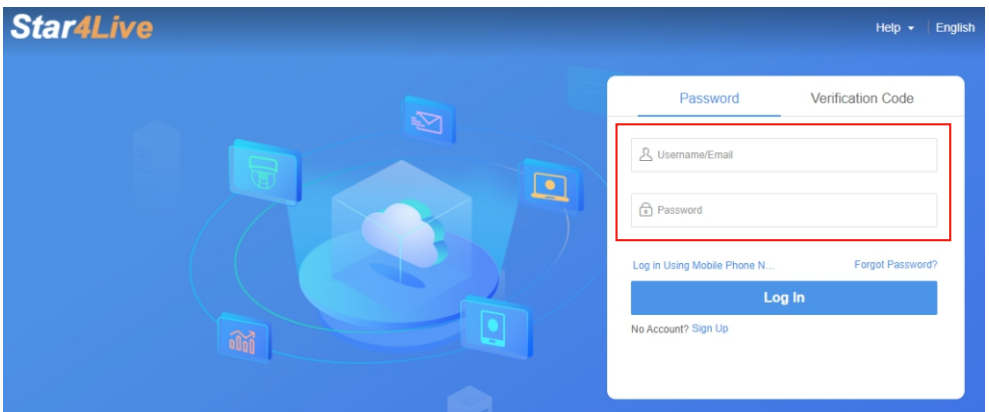

4. Download the web plugin, close your browser, and install the plugin.

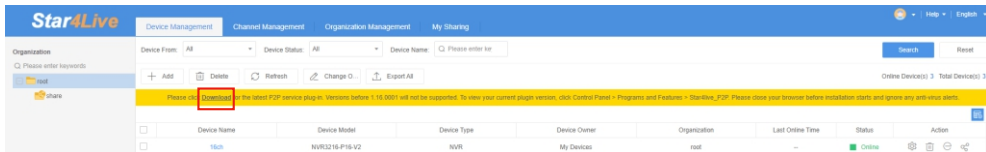

5. Return to www.star4live.com and log in again. Click  on the right side to open the web client.

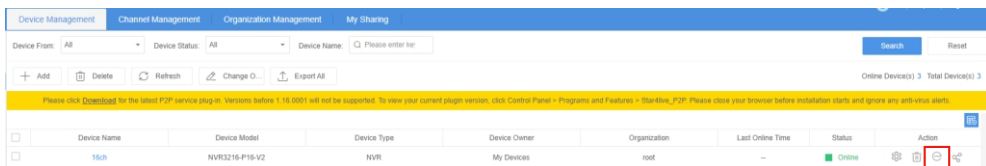

6. Download the additional web plugin and refresh the page.

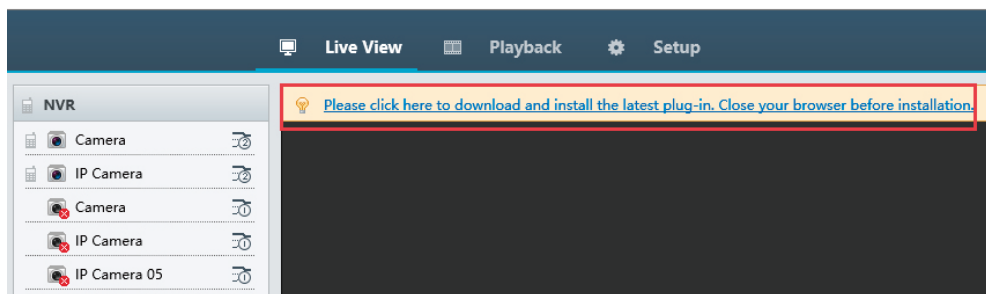

7. Drag the cameras one by one to the device windows on the right to view video.

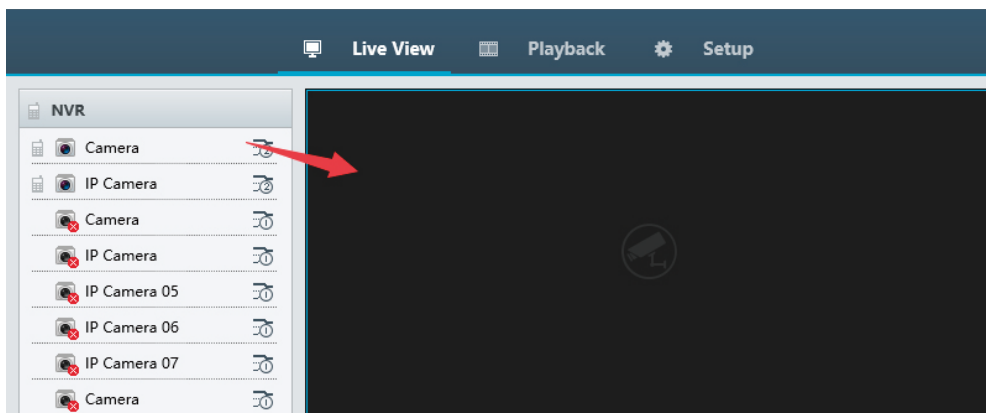

Set the Detection Area

1. Set the Motion Detection Area

Right-click on the NVR monitor and go to **Menu --> Alarm --> Motion**. Select a camera at the top. Click **Clear All**, then draw an area on the image to configure the motion detection area. Click **Apply** to save the changes.

*Tip: **Motion Mode** detects all movements. **Smart Motion Detection** detects only humans and vehicles. The default detection mode is Smart Motion Detection. The area covered by red boxes is the detection area.*

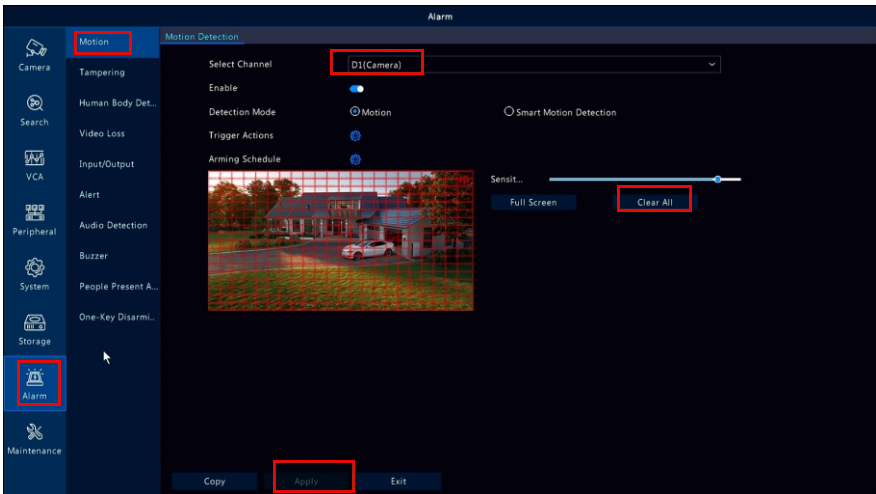

2. Set AI Detection Area

Attention: Some ONWOTE camera systems do not support AI functions. You can use only one AI feature at a time. AI Detection cannot work simultaneously with Smart Motion Detection (Human & Vehicle Detection). If you enable an AI function, Smart Motion Detection will be turned off.

Right-click on the NVR monitor and go to **Menu --> VCA --> VCA Config**. Select a camera at the top, then enable the AI function you want to use. The following instructions use Face Detection as an example.

Click  on the right side of **Face Detection**. Click **Draw Area** to draw a detection area on the image. Click **Apply** at the bottom to save the changes.

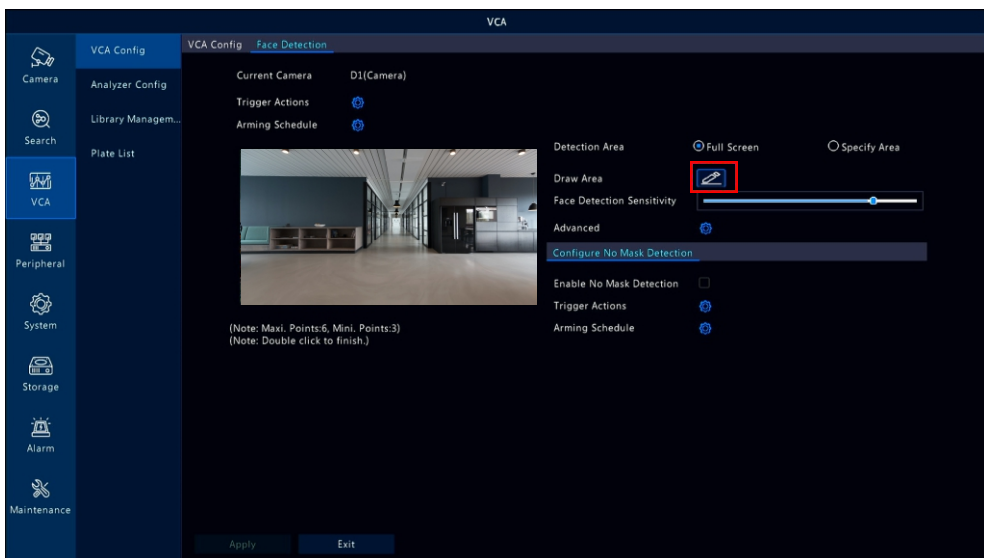
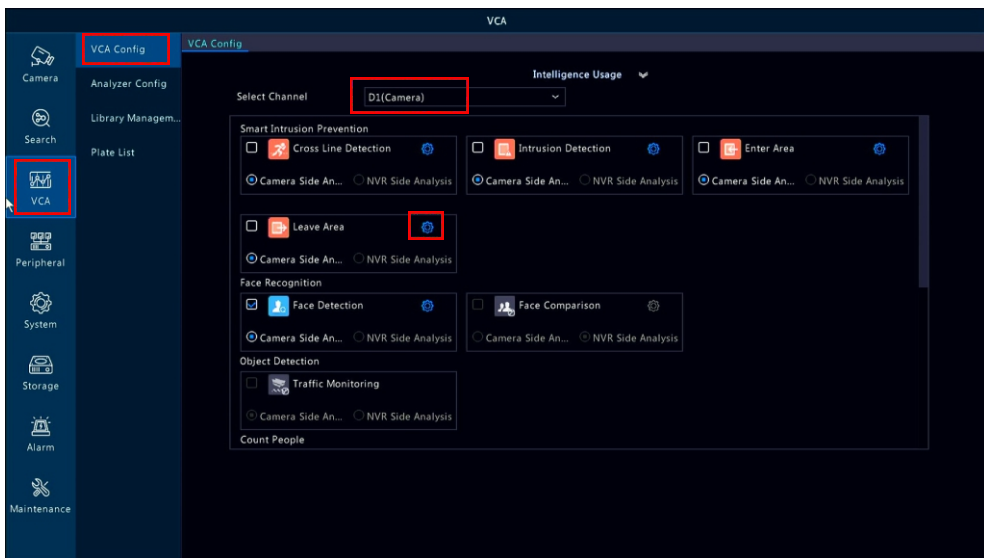

Recording Setup

Right-click on the NVR monitor and go to **Menu --> Storage--> Recording** to configure recording settings.

a) Normal Recording (24/7 Full-Time Recording + Smart Motion Recording)

This is the default recording mode. The system records continuously and highlights Smart Motion Detection events in a different color (Smart Motion Detection refers to Human & Vehicle Detection).

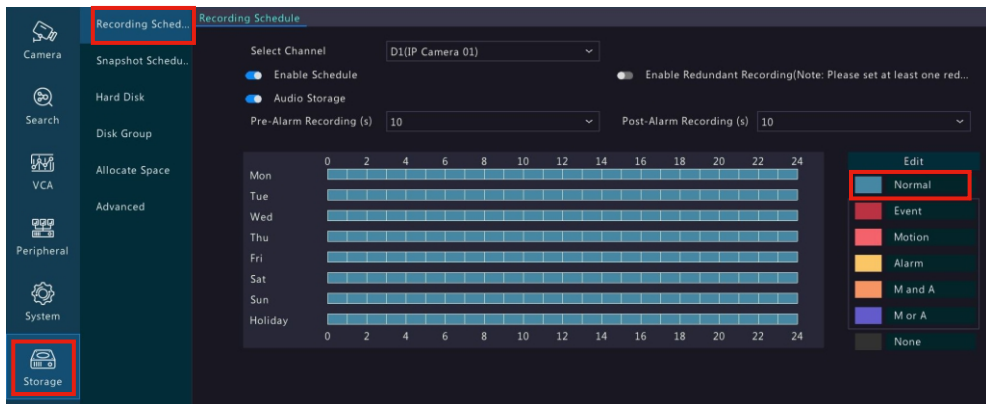

b) Event Recording (If AI Detection is enabled, the NVR records only when an AI detection event is triggered.)

1. Click **Event**, press and hold the left mouse button, then drag to select the time.



2. Click **Copy**, select **All**, and click **OK** to copy the settings to all channels.

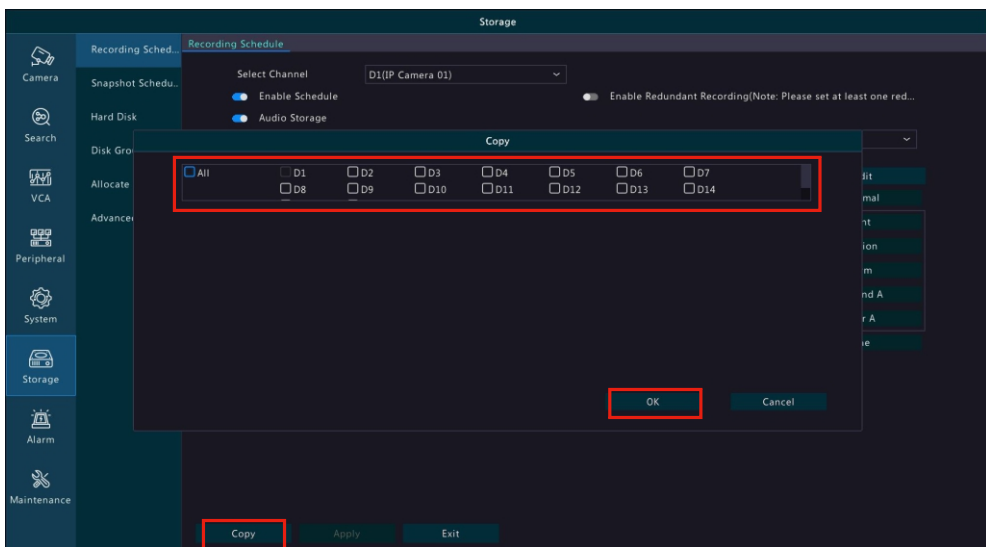

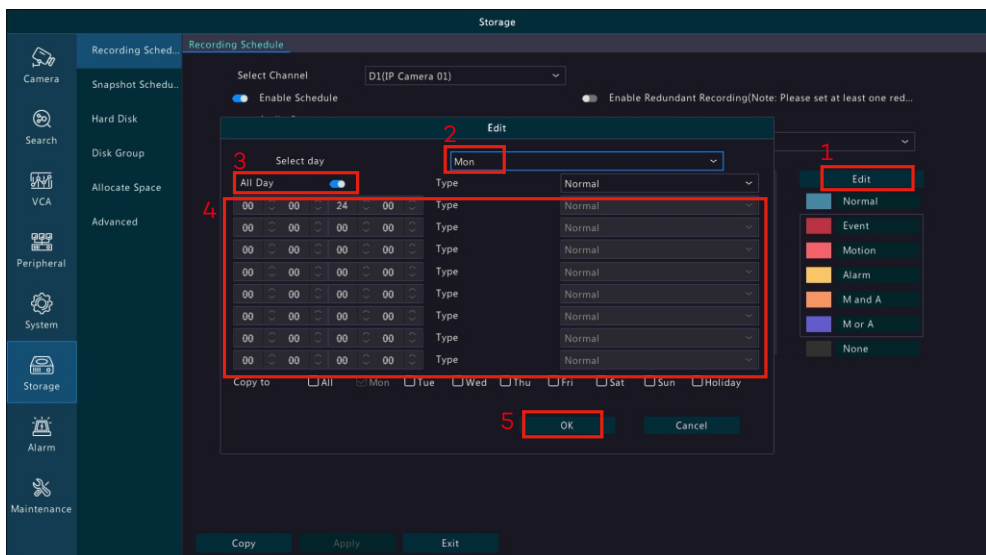

Recording Schedule Setup

1. Click **Edit** on the right side.
2. Select a day.
3. Clear **All Day** checkbox.
4. Manually set the time and select the recording mode for each period.
5. Click **OK** to save changes.



a) Playback on the NVR

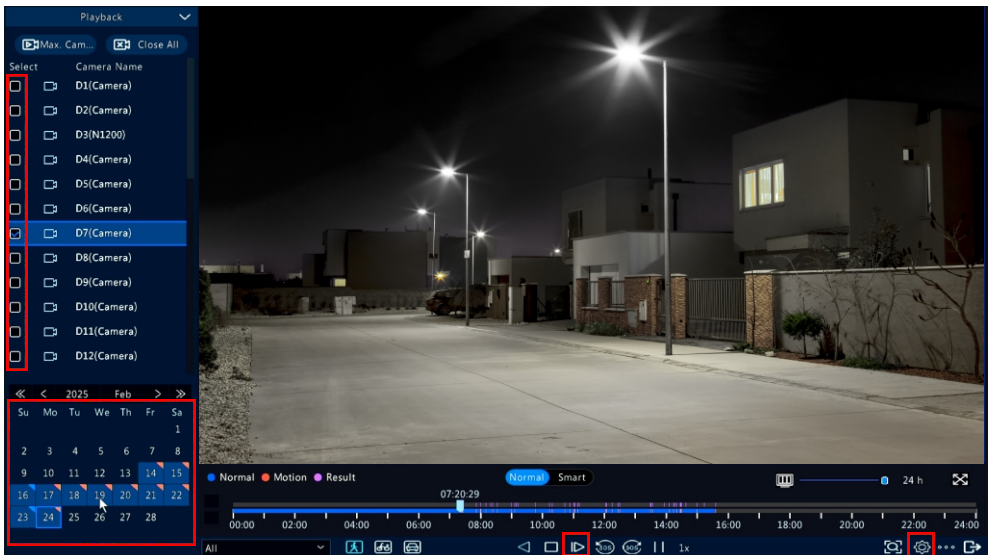

1. Right-click on the NVR monitor and select **Playback**.
2. Select the cameras and date, then click  in the upper-right corner, change **HD** to **SD** in the lower-right corner to view more cameras simultaneously.
3. Click  to start playback.



b) Playback via Browser

1. Enter www.star4live.com in your browser address bar.
2. Log in with your account.

Tip: If you have not registered an account, click **Sign Up** and follow **Step d-f** on **page 16** to register an account and add the device.

3. Click  on the right side, click **Playback** at the top, select the cameras and date, then click  to start playback.

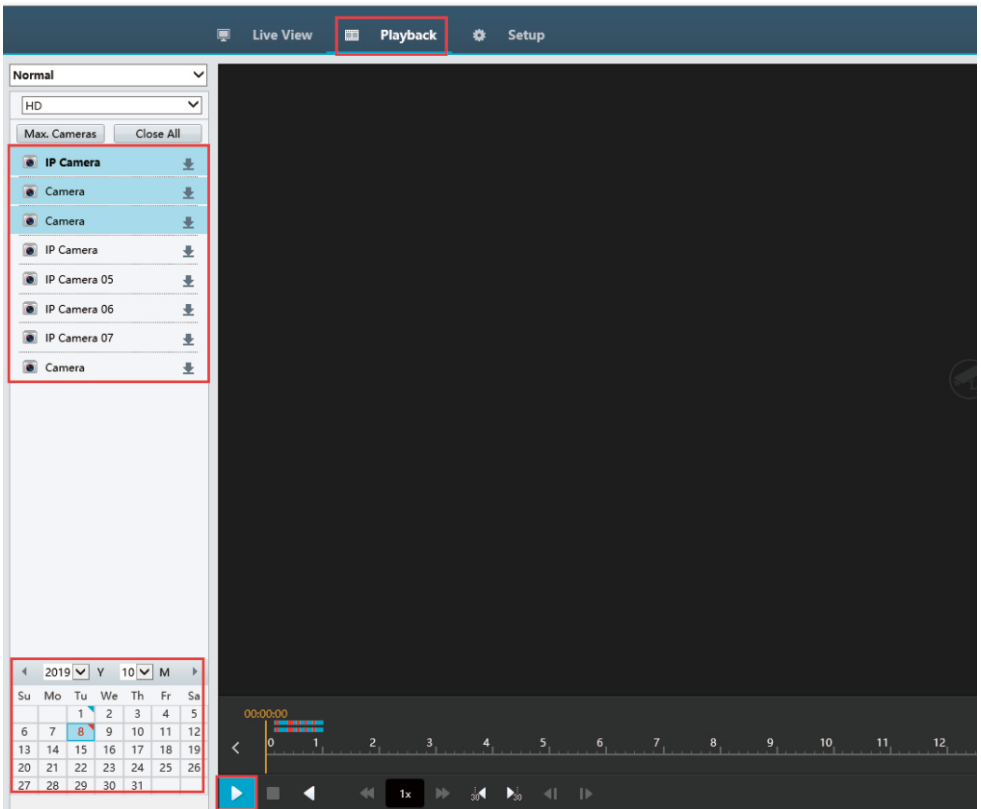
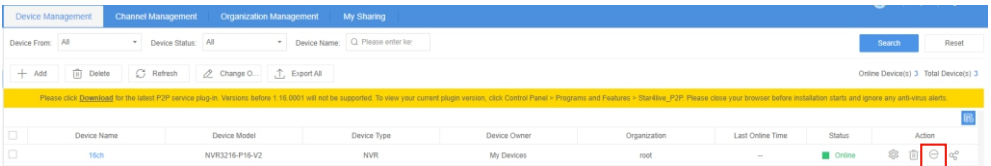

c) Playback via PC Client Software- Guard Station

1. Open the PC Client Software, go to **Control Panel**, and click **Playback**.
2. Select the Recording Playback mode. The default mode is Normal Recording Playback.
3. Select the device and date, then click **Search** to start playback.

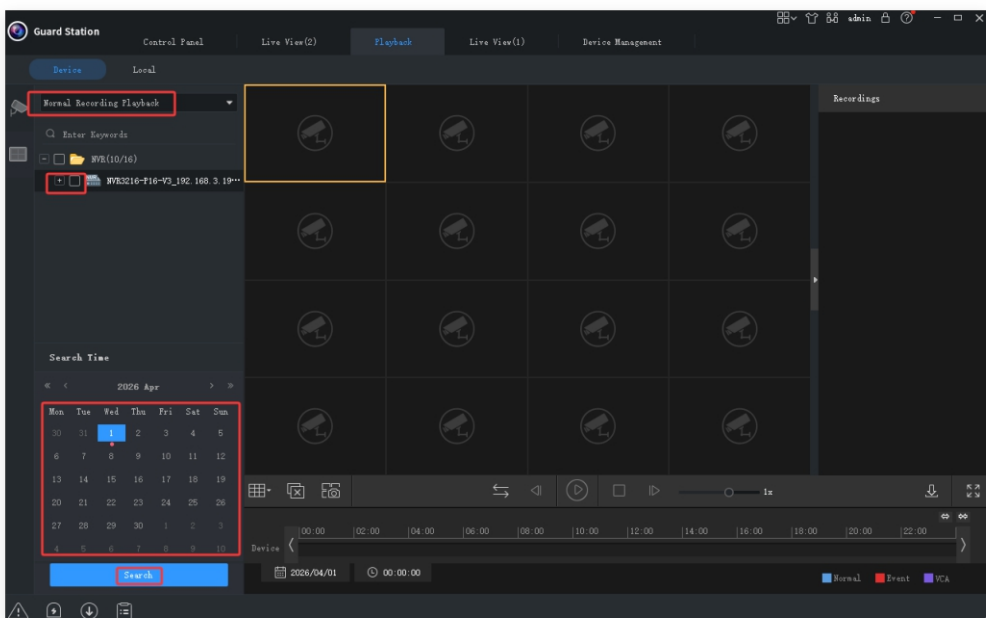
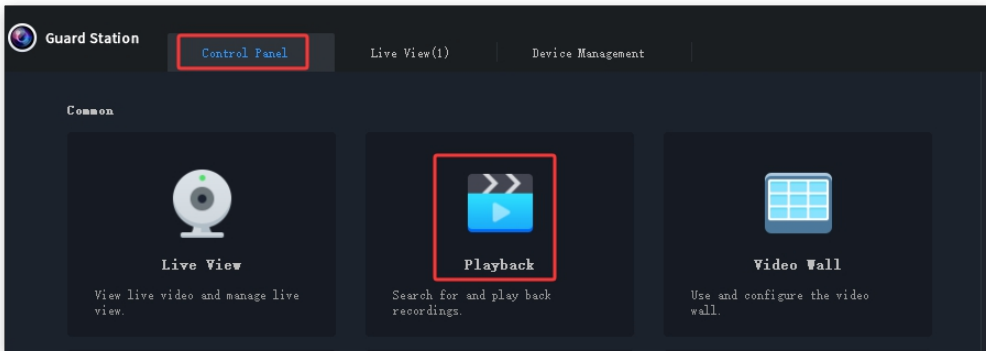

Note: Use **VLC Media Player** to play backup files.

a) Backup on the NVR

1. Insert a USB drive into the NVR USB port. Right-click on the NVR monitor and go to **Menu --> Search --> Video**. Select the camera, date and time, then click **Search**.

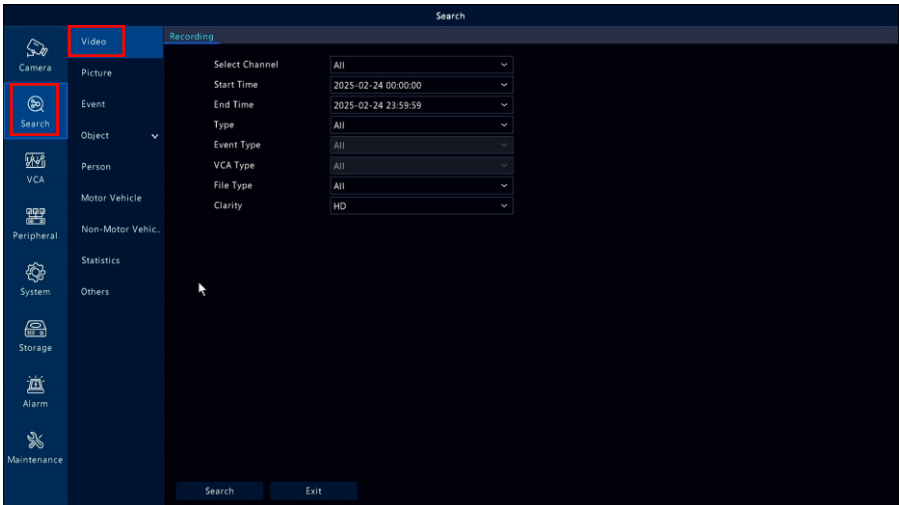

2. Select the recordings and click **Backup** to continue.

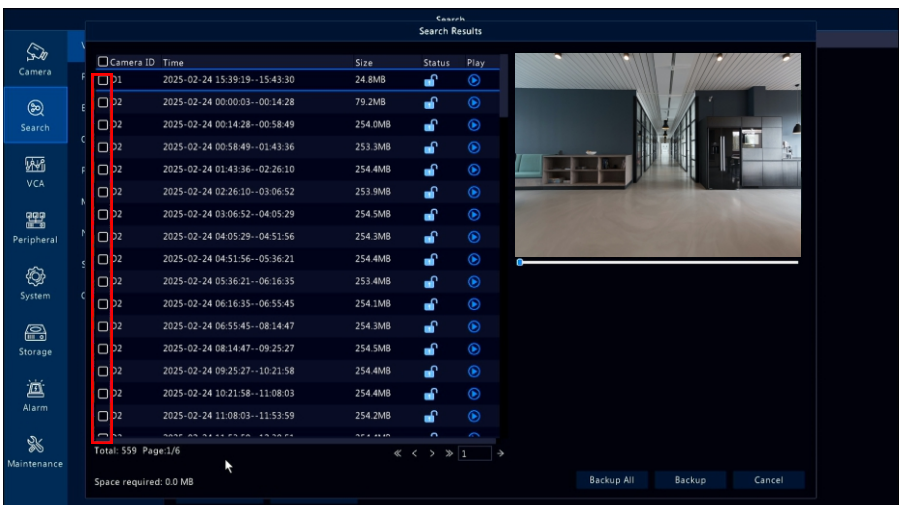

3. Choose the USB drive, select a folder, and click **Backup** to back up the recordings.

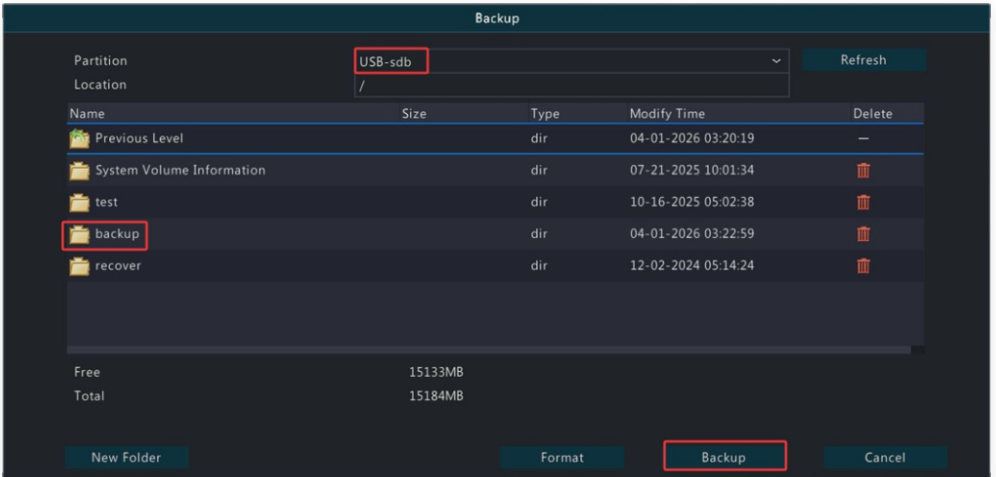

b) Backup via Browser

1. Run your browser as administrator.

2. Enter www.star4live.com in the browser address bar.

3. Log in with your account.

Tip: If you have not registered an account, click **Sign Up** and follow **Step d-f** on **page 16** to register an account and add the device.

4. Click  , then choose **Playback**.

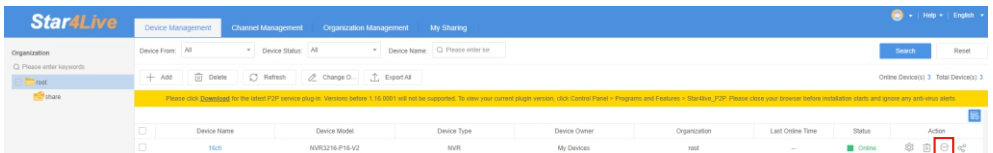

5. Click  next to the camera.

6. Select the camera, date, and time, then click **Query**.

7. Select the files and click **Download** to back up the recordings.

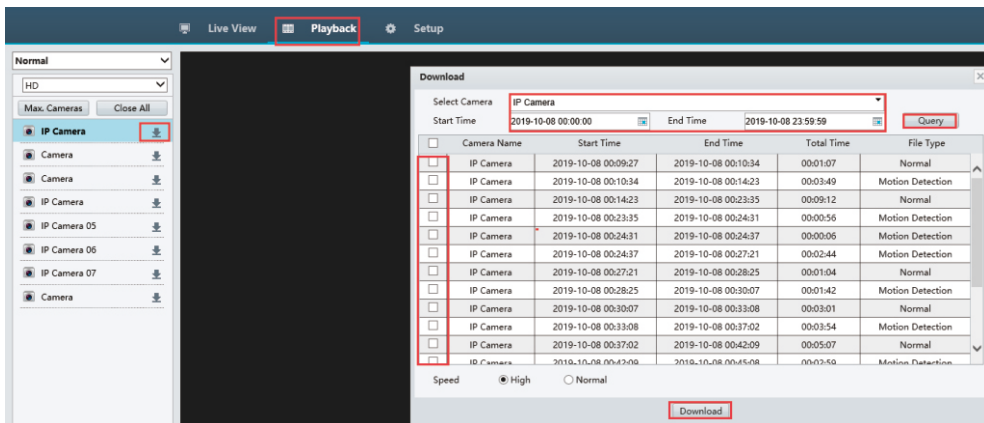

c) Backup via PC Software- Guard Station

1. Open the PC client software, go to **Control Panel** and click **Playback**.

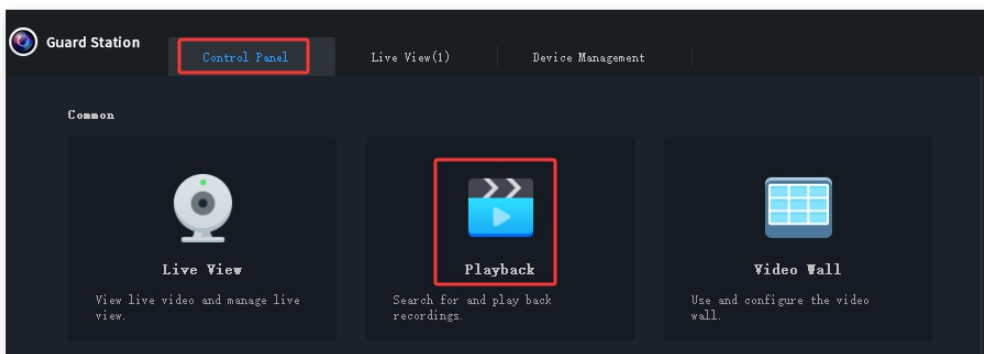

2. Click  in the lower left corner.

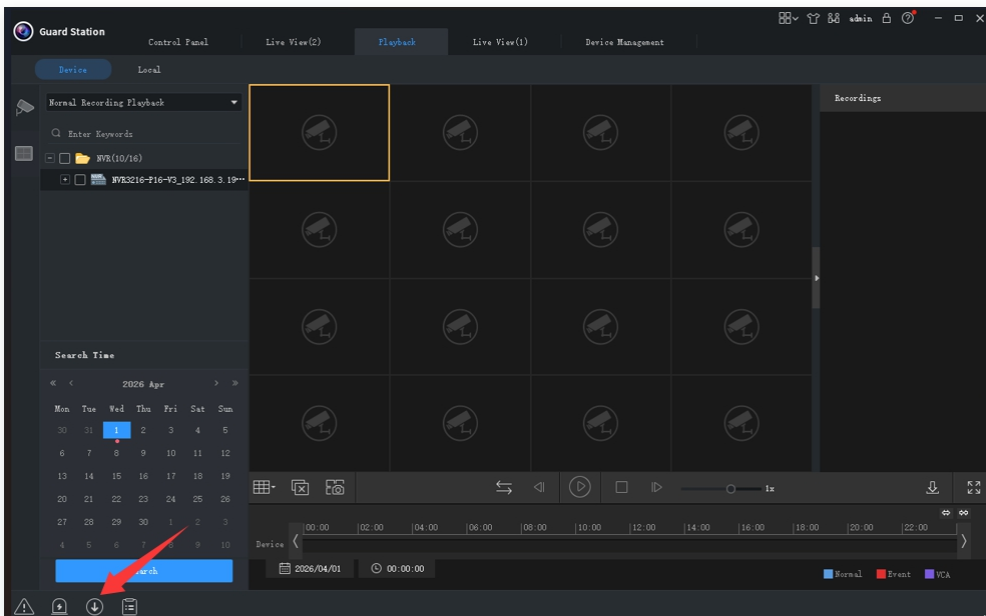

3. Click **By File**, select the device, select the time, and click **Search**.

4. Select the files and click **Download** to back up the recordings.

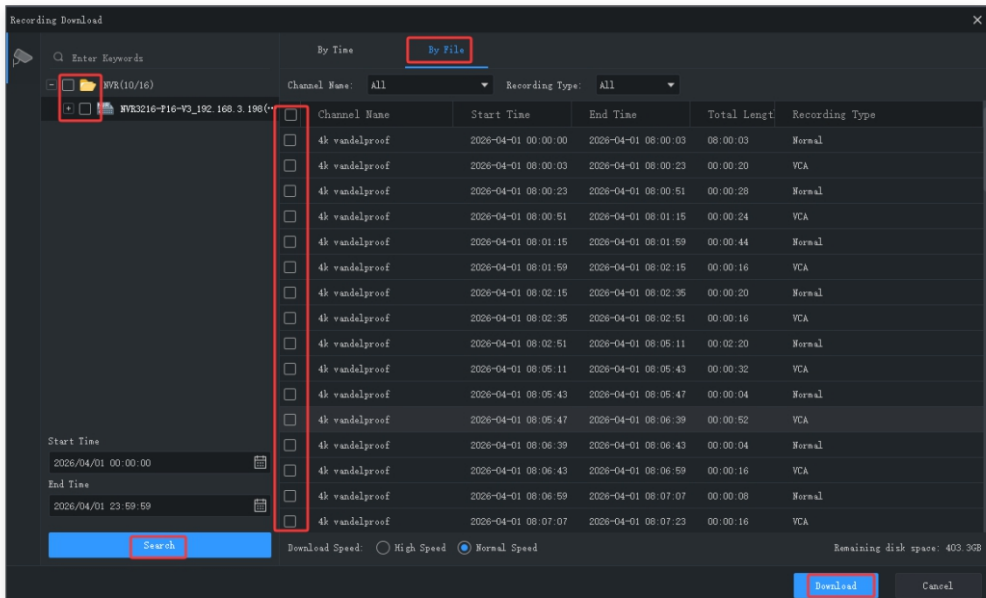

5. Click  in the lower-left corner to check the download progress.

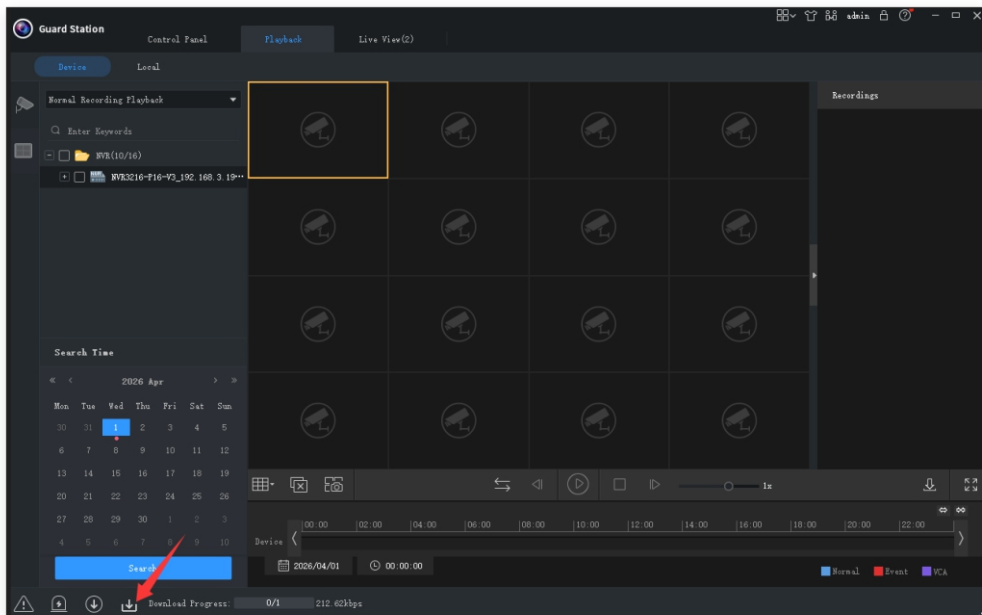

6. Click  to open the folder and find the downloaded file.

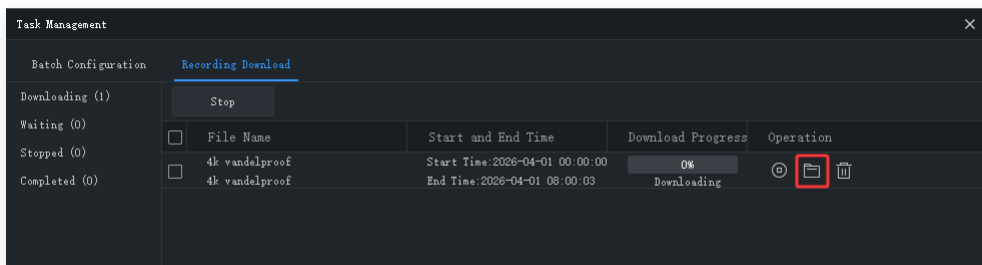

Mobile App Alarm

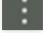
Open mobile app-**Elink Defense**. Tap  on the right, enable **Receive Alarm Message**.

*Tips: Please double-check your mobile phone's notification settings and make sure **Elink Defense** is allowed to send notifications.*

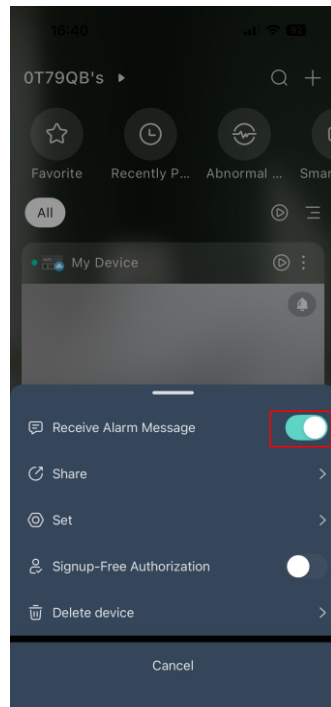
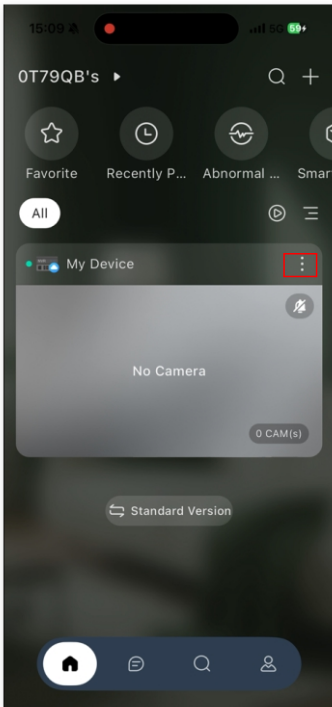

E-mail Notifications

1. Right-click on the NVR monitor and go to **Menu --> System--> Network > Email**.
2. Enable **Server Authentication** and **TLS/SSL**. Enter the sender and recipient information, then click **Apply**.

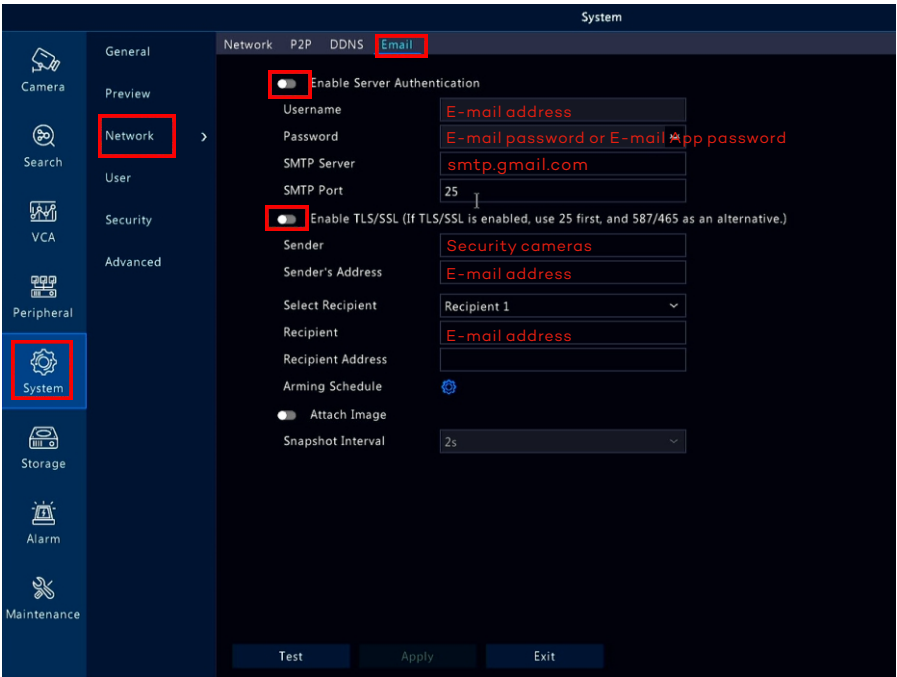

(The information shown in the image above is for reference only)

3. Click Test to verify the E-mail settings.

(Contact your email service provider if you have difficulty configuring SMTP email settings)

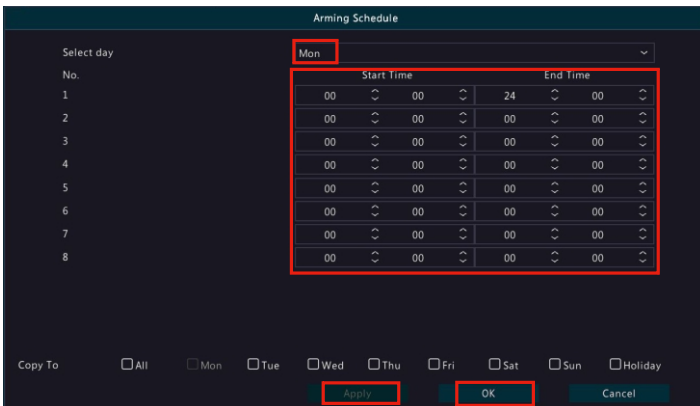

4. **Set the Alarm Schedule for Email Alerts** (the default schedule is 24/7).

Click  next to **Arming Schedule**, select a day, set the time, select the days under **Copy To** to copy the schedule, then click **Apply** and **OK** to save it.

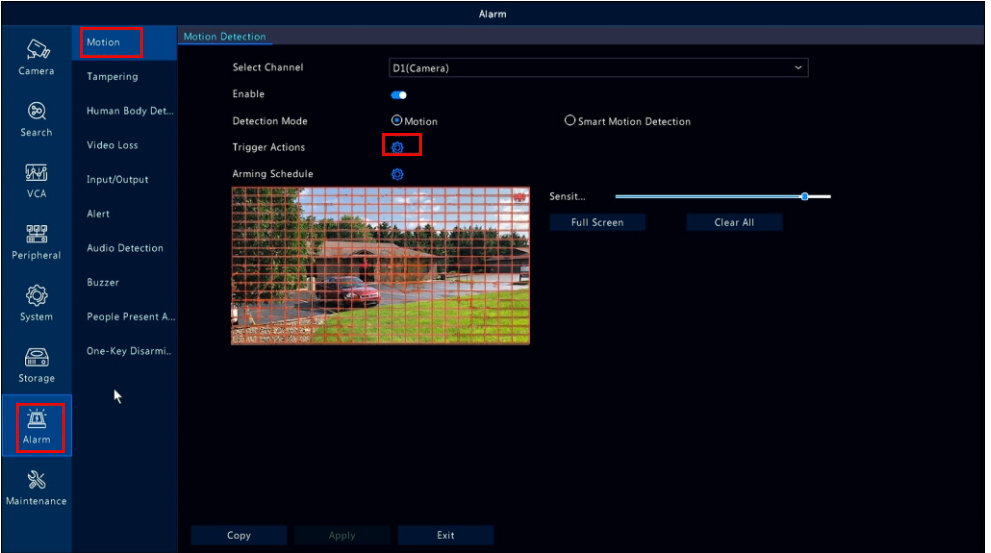

5. Go to **Alarm-- > Motion**, select the camera, and click  next to Trigger Actions.



If **AI Detection** is enabled, go to **VCA --> VCA Config**. Click  next to the selected AI feature, then click  next to **Trigger Actions**. The following descriptions use Face Detection as an example.

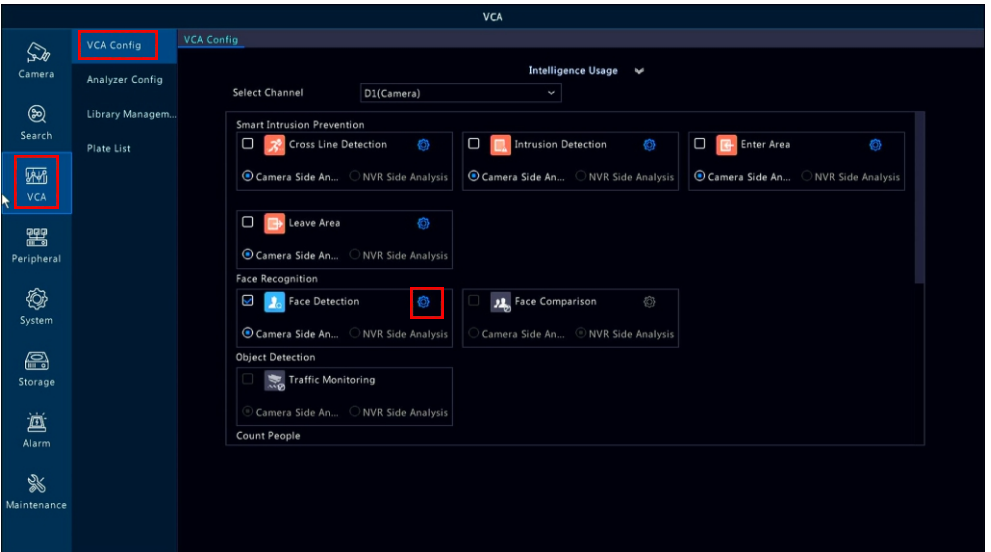

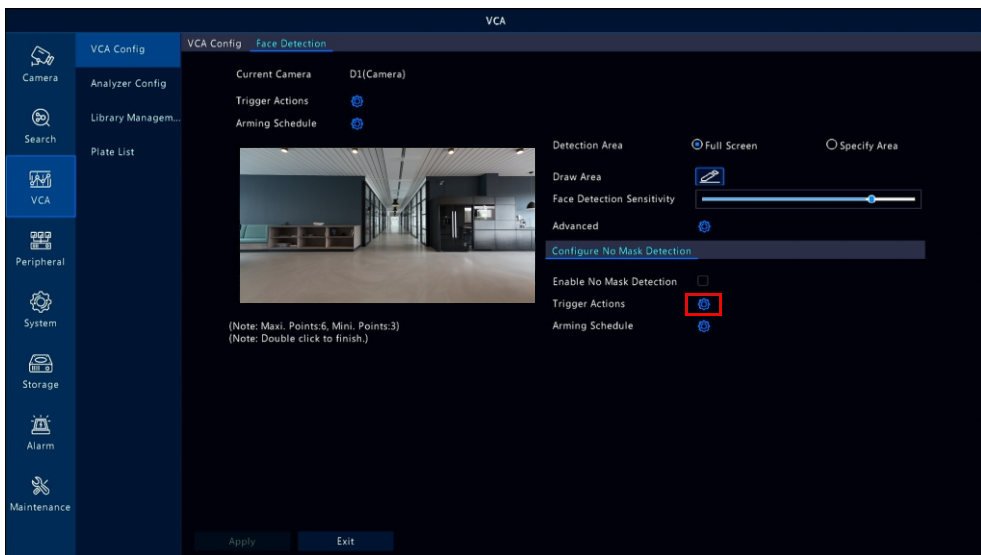

6. Choose **Send Email**, select the recipient, click **Apply** and **OK** to save the changes.

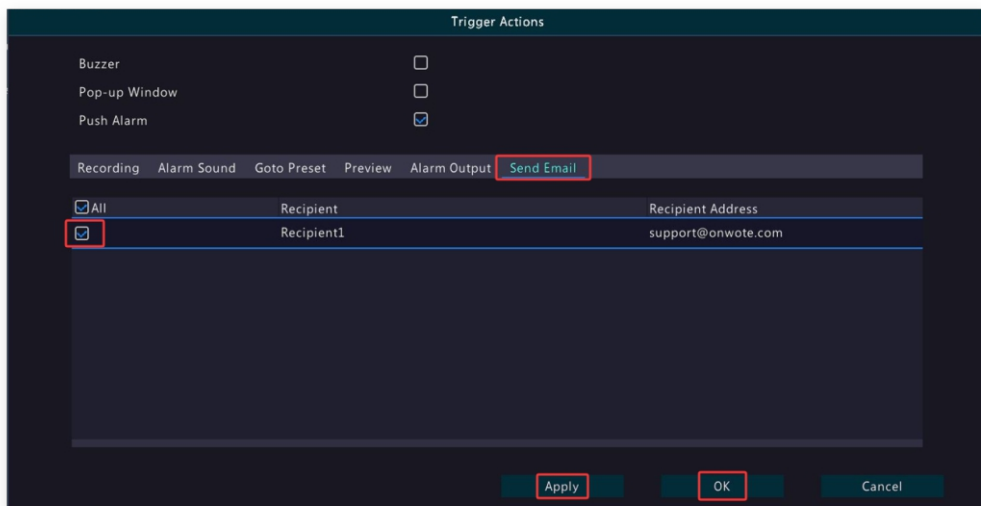

*Tip: **Send Email** has been enabled only for the selected camera. To enable it for other cameras, select each camera and repeat the same steps.*

Attention: Some ONWOTE camera systems do not support Smart Motion Detection or AI/VCA Detection.

Smart Motion Detection (Human & Vehicle Detection)

This is the default detection mode. Right-click on the NVR monitor and go to **Menu --> Alarm --> Motion** to manage **Smart Motion Detection** settings.

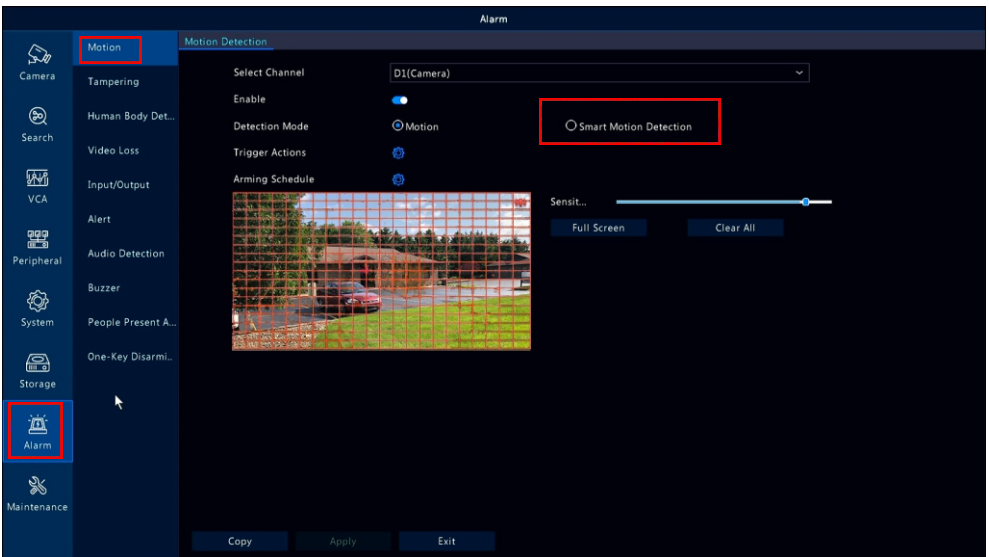

AI/VCA Detection

Right-click on the NVR monitor and go to **Menu --> VCA --> VCA Config**. Select the AI function you need, then click  next to the selected AI feature to adjust the detailed settings.

Note: You can use only one AI feature at a time. AI Detection cannot operate simultaneously with Smart Motion Detection (Human & Vehicle Detection). If you enable an AI function, Smart Motion Detection will be turned off.

For more information about AI/VCA Detection setup, visit www.onwote.com and go to **Support --> Download --> Manual--> NVR30 Series**.

AcuSearch

Switch the NVR to AcuSearch Mode

Right-click and go to **Menu-- > VCA-- > Analyzer Config**, then select **AcuSearch (Human Body/Motor Vehicle)**.

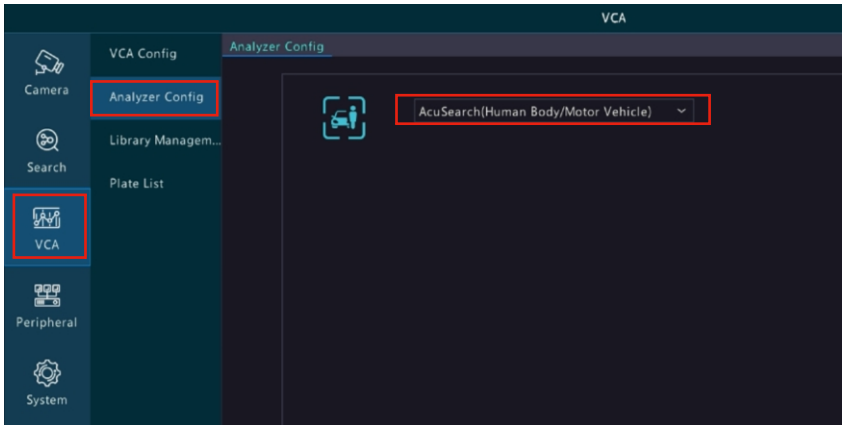

1. AcuSearch on Live Video

1) Left-click the live video, then click  .



2) Draw a box around the person you want to search for. Select the entire body if possible, then click **OK** to search.

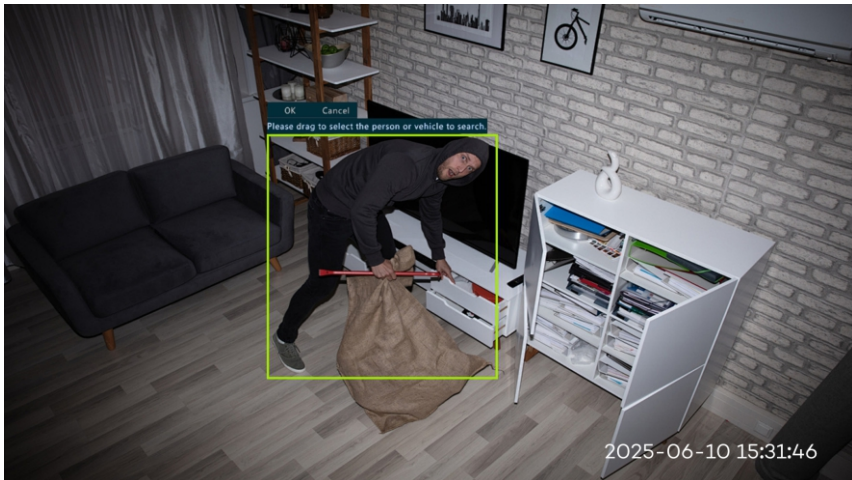

3) Select the pictures and videos you need, then click  to back them up.

Tips: 1. Insert a USB drive into the NVR USB port before backing up files.

*2. Adjust **Date and Time**, **Cameras**, and **Similarity** at the bottom of the screen to refine the search.*

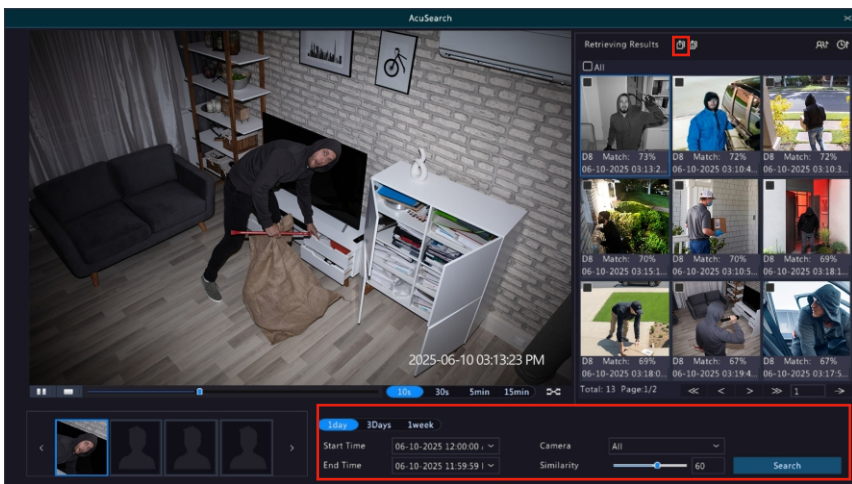

2. AcuSearch during Playback

1) Right-click and select **Playback**. Select the camera and date for playback, then click  in the lower-right corner.

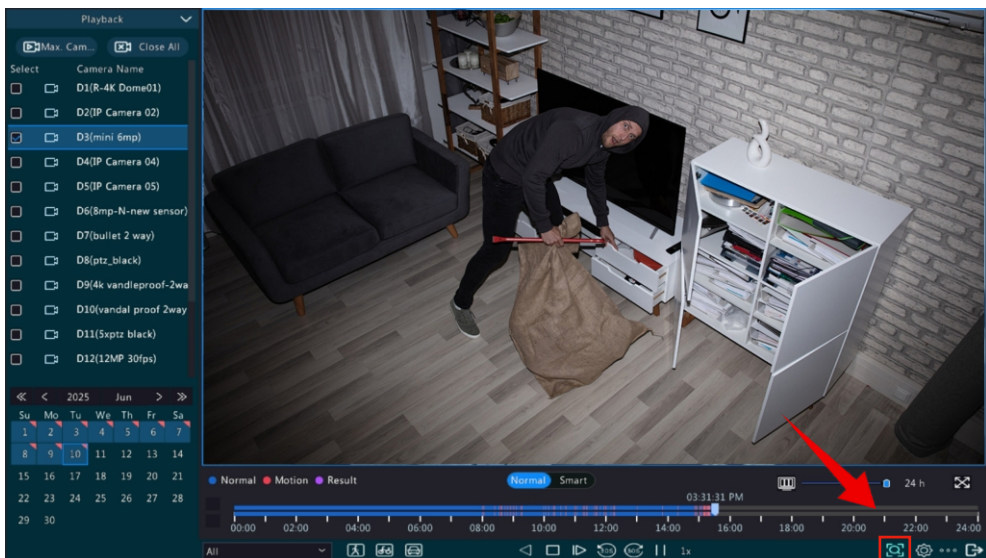

2) Draw a box around the person you want to search for. Select the entire body if possible, then click **OK** to search.

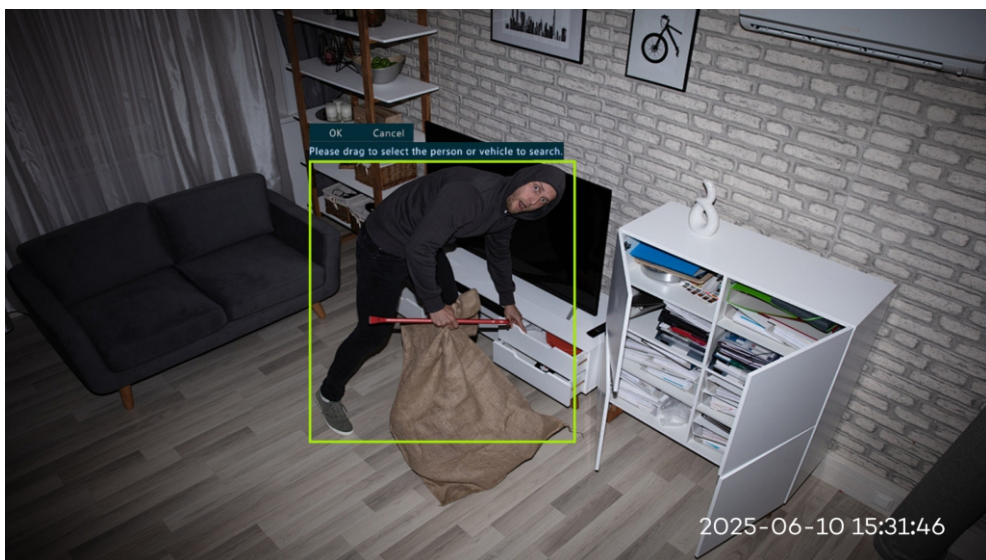

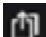
3) Select the pictures and videos you need, then click  to back them up.

Tips: 1. Insert a USB drive into the NVR USB port before backing up files.

*2. Adjust **Date and Time**, **Cameras**, and **Similarity** at the bottom of the screen to refine the search.*

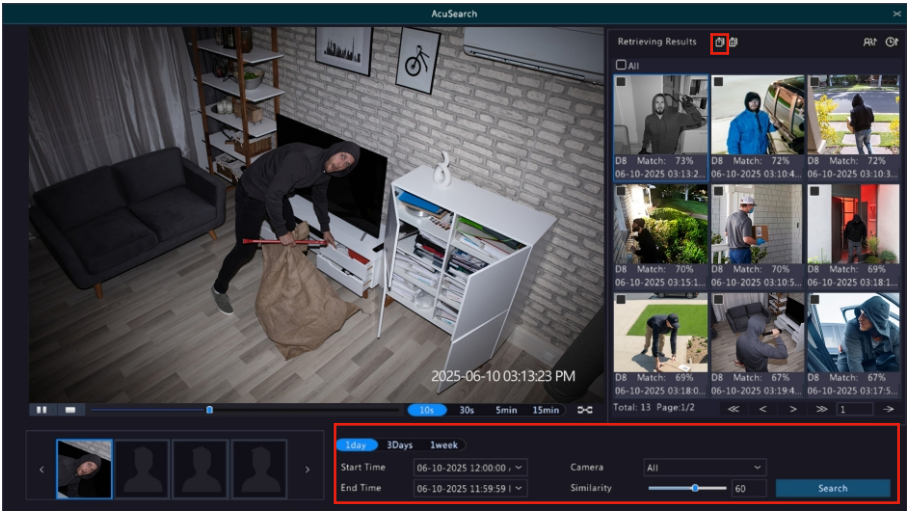

Face Comparison

1. Switch the NVR to Face Recognition Mode

Right-click on the monitor, go to **Menu --> VCA-- > Analyzer Config**, and select **Face Recognition**.

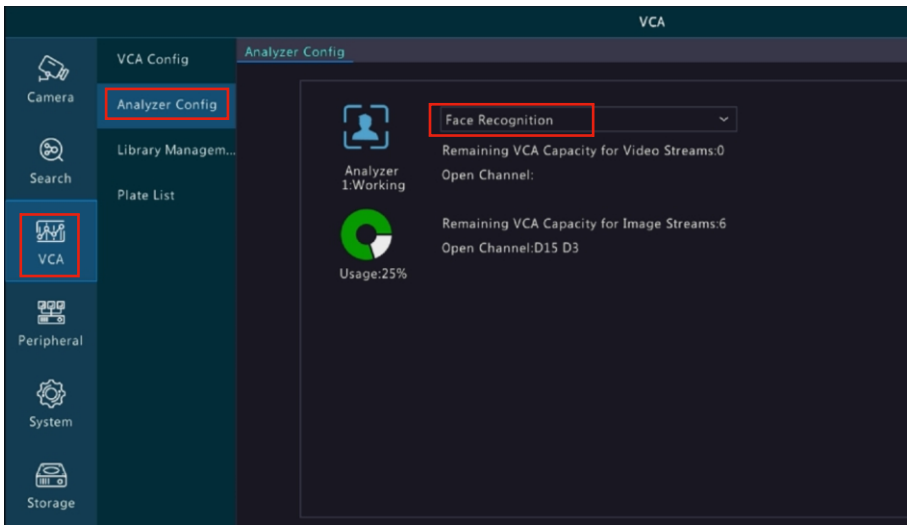

2. Enable Face Detection and Face Comparison

Go to **VCA-- > VCA Config**. Select a camera at the top, then enable **Face Detection** and **Face Comparison**.

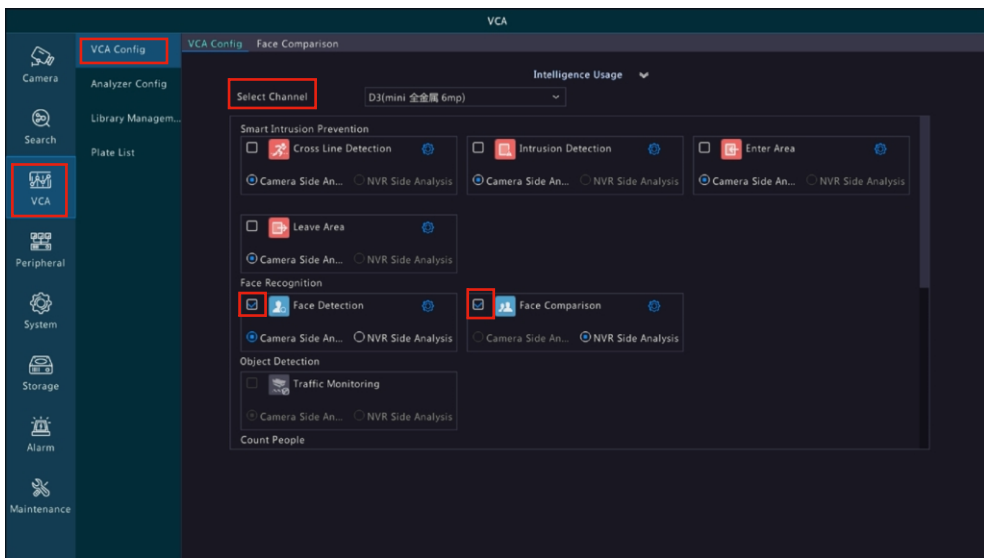

3. Set the face list

1) Go to **VCA --> Library Management**, then click **+Add** to add a Face List.

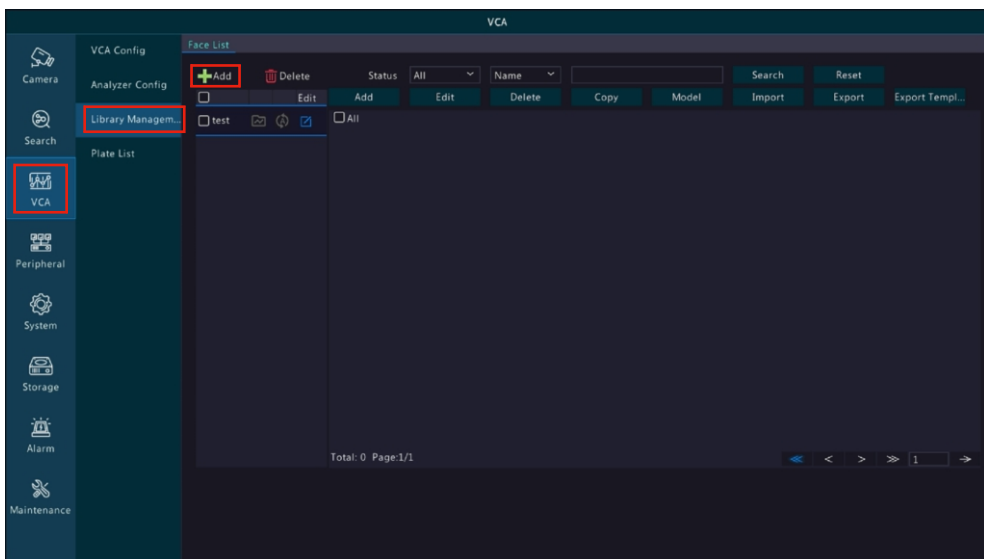

2) Click **Add** to add Face Information.

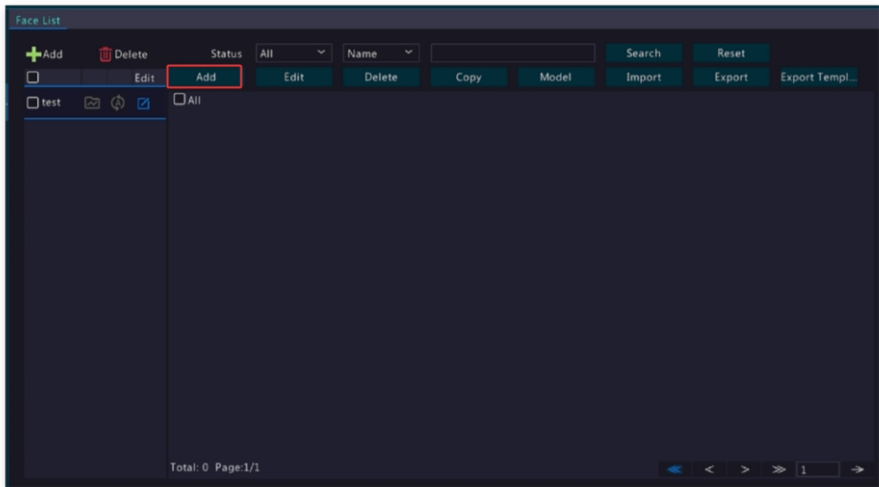

3) Click **Select Image** to upload an image. Enter the additional face information, then click OK to save it.

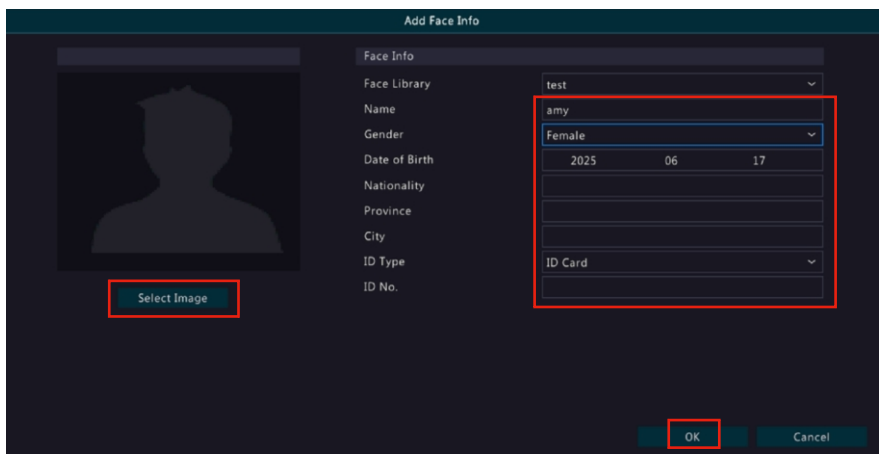

*Tips: To select a face detected by the cameras, go to NVR **Menu**-- > **Search**-- > **Person** --> **People Search** --> **Face Snapshot** to search for faces and add them to the Face List.*

4.Set Up a Face Comparison Monitoring Task

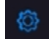
1)Go to **VCA** --> **VCA Config**, select a camera at the top, then click  next to Face Comparison.

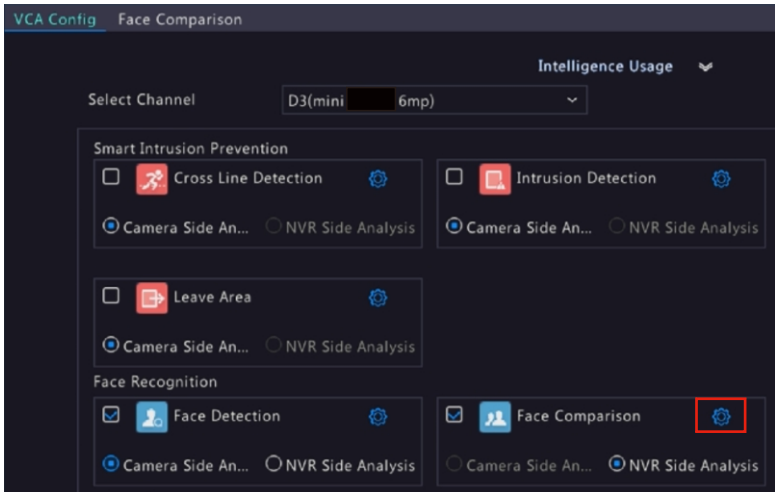

2) Click **Add Monitoring Task** and configure the monitoring task according to your needs.

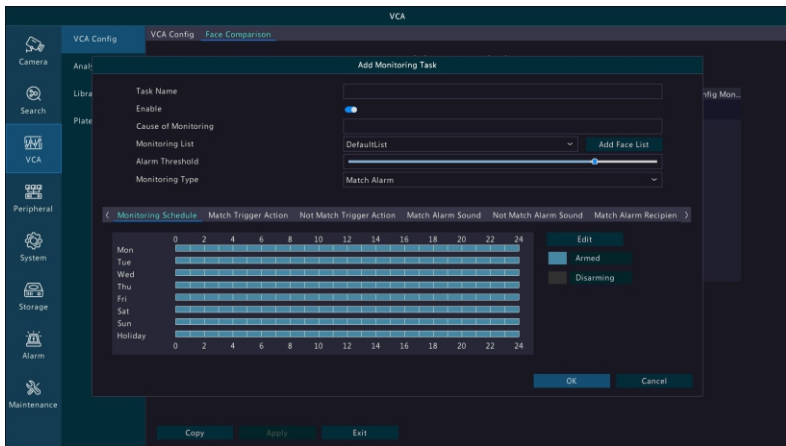

Notice:

- If you use cameras with red and blue warning lights, select Alarm Output to enable the warning lights. For example, selecting D1- > 1 triggers the red and blue warning lights of camera D1.
- If an external alarm is connected to the back panel of the NVR, select **A -> 1** and **A -> 2** to trigger the external alarm.
- **Buzzer** refers to the internal buzzer inside the NVR.
- **Push Alarm** refers to the alarm message displayed on the NVR monitor.
- **Alarm Sound** is used for an external IP speaker.

1. Click **Forget Password**

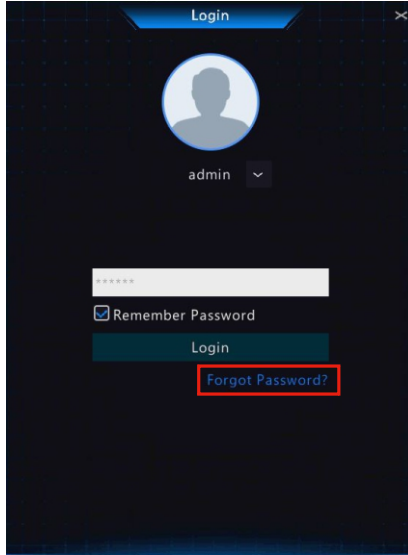

2. Enter an E-mail address and click **Next**.

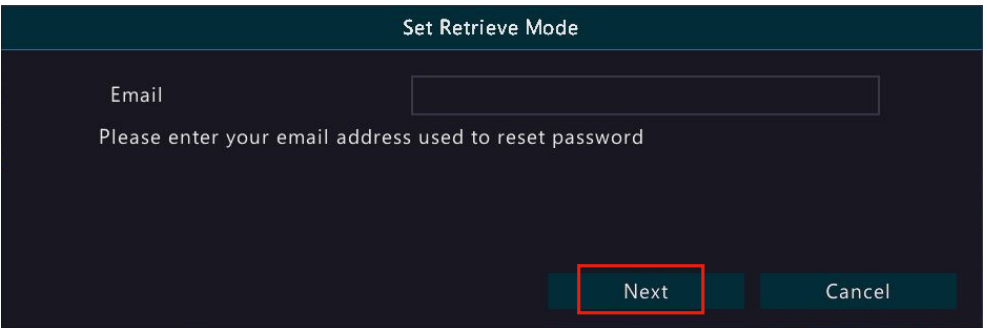

3. A QR code will appear, as shown below.

Retrieve Password

Serial No.

Email

sup****@onwote.com

Security Code



Please scan the QR code to obtain the security code:

Scan with your app

For administrator only

OK

Back

4. Open the **Elink Defense** mobile app on your phone, tap  at the bottom, then select **Forgot Device Password**. Scan the QR code on the reset page to obtain a security code.

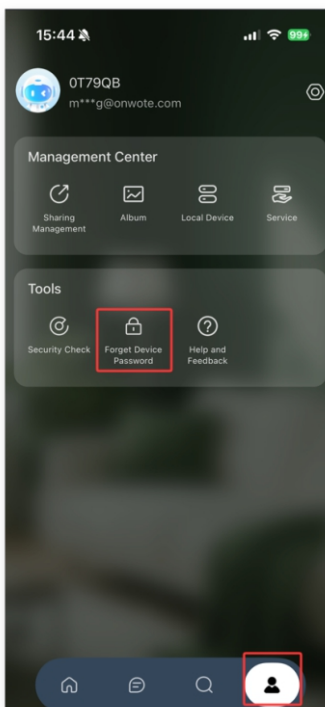

5. Check the security code in your E-mail inbox. If you cannot find it, check the Spam or Trash folder. Enter the code on the monitor and click OK to reset the password.

Retrieve Password

Serial No.

Email sup****@onwote.com

Security Code



Please scan the QR code to obtain the security code:
Scan with your app

For administrator only

**COMMERCIAL POE DEFINED
EXPERT CARE ALIGNED**